

WHITE ENSIGN MODELS

WW2 German Anti Aircraft Weapons

Photo Etched replacement parts for Kriegsmarine
Warship Model Kits

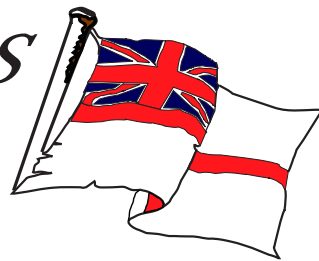

© WHITE ENSIGN MODELS 2000

20mm C/38 Vierlinge

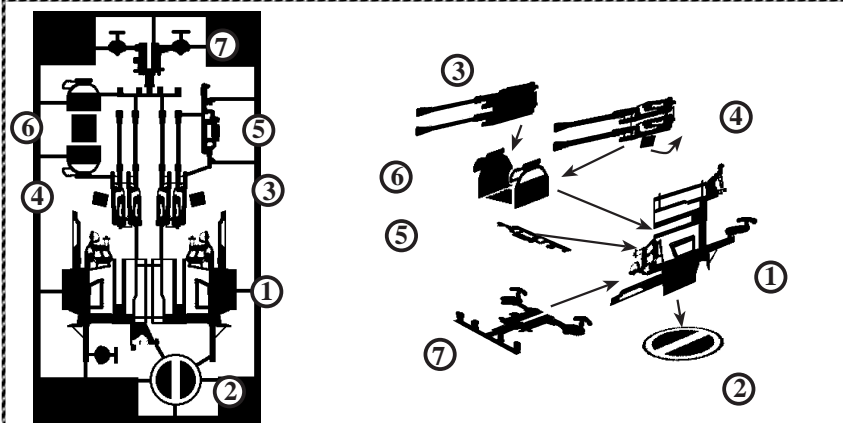

- Carefully remove parts from fret using sharp blade. Part 1 is double sided and needs to be folded in half along a line that runs along the top of the mounting. Bend the trainer's seat into position as shown in the diagram.
- Fold part 6 into the shape shown and fit centrally into the slot in part 1. Fit the barrels parts 3 & 4 so that the breech mechanisms fit onto the rectangular plates on the sides of part 6. The barrels must remain parallel in relation to each other but may be fitted elevated to almost any angle short of vertical.
- Bend up the footrests and seat backs of the gun layer's position, part 7, into the shape shown and fit into the lower slot on part 1. Fit the sight bar onto the protrusion above, slightly offset to the left.
- Fit completed assembly to base plate part 2.

20mm C/30 Single Mounting

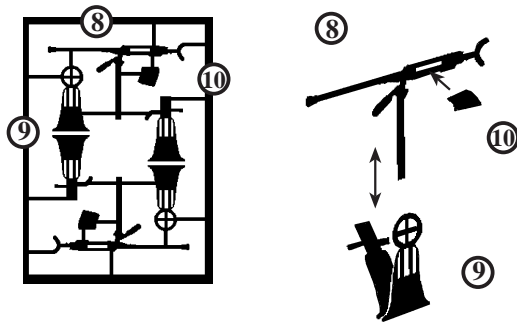

- Note. There are two 20mm mountings in each section of fret. Remove the parts of each one carefully and assemble as shown above.
- The long extension beneath the gun barrel is a ram to raise and lower the pivot point when elevating the gun to high angles. The gun can be elevated to a high angle by bending it back on the narrow neck below the breech. The ram is then raised to an appropriate height to allow the gunner to access the firing mechanism. The ram is fixed in position by sandwiching it between the two halves of part 9.

20mm C/30 Vierlinge

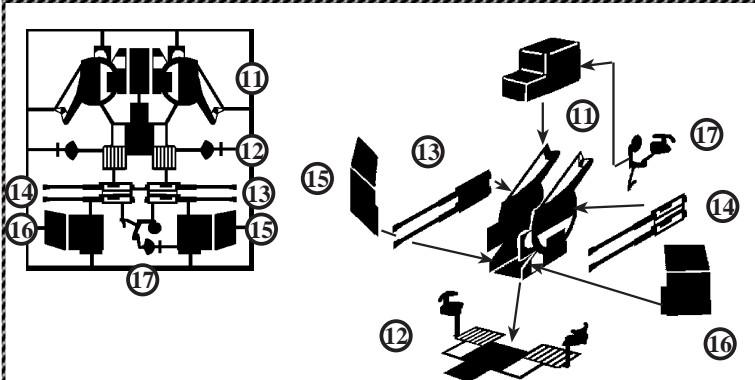

- Fold up the sides of the main part 11, and manufacture a filler piece out of plastic strip to fit between the two plates as shown. This plastic piece will also provide a mounting for the trainer's seat part 17 to fit onto.
- Fit barrels 13 & 14 to the rectangular plate each side of part 11, as shown. The barrels may be fitted in the elevated position but ensure that both sides remain parallel to each other.
- Bend the ammunition feeders' seats on part 12 into the position shown and assemble to part 11. Note: ammunition storage boxes can be made out of plastic card and fitted to the blank relief etched area on either side of the footplate. These should come up to the height of the etched area at the base of part 11.
- Fit shields parts 15 & 16 to either side of part 11. The tops of the shield are angled back slightly as are the shields themselves when fitted to the mounting.

37mm M/43 Doppelaffette

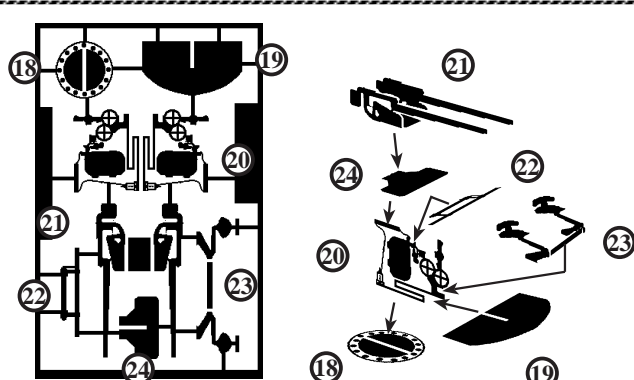

- Fold up the barrels either side of the mounting plate of part 21 and fit centrally and slightly to rear of part 24.
- Fold part 20 up from the bottom so that both side are relief etched, and fit to the underside of part 24. Fit the footplate part 19 into the slot in the front of part 20 as shown and fit completed assembly to the circular base plate part 18.
- Fold the gun layer's seat mountings around as shown, then bend the seats into position, facing front. Fit the bar into the slot under the training wheels.
- Fit the sight bar centrally into the recess below the barrel mounting plate.

General Instructions

- Do not remove the etched parts from the fret until you are ready to use them.
- Before assembly, soak the etched parts in a suitable solvent, such as white spirit, to de-grease the surfaces for painting.
- Cyanoacrylate adhesive (Super glue) or contact adhesive such as Elmers white glue may be used. These can be applied with a pin or piece of stretched sprue.
- When removing parts from the fret, place the fret on a hard surface, such as a smooth ceramic tile, in order to prevent parts bending whilst cutting through the holding tabs. It is suggested that a #11 type of modelling knife blade is used for this purpose.
- When shaping or bending a part, a straight edged blade such as a chisel blade #17 or #18 will give a good sharp corner, or alternatively a small pair of smooth jawed pliers may be used.
- If a part is bent incorrectly, lay it on a hard flat surface and roll it flat with a cylindrical object such as a modelling knife handle.
- It is suggested that rails are pre-measured, where practical, using a pair of compass dividers and then tacked to the deck edge every third or fourth stanchion with a small drop of glue. When a section is complete, run a thin line of glue along the inside edge to attach it firmly to the deck.

We hope that you will find this set to your satisfaction and that you enjoy assembling the fittings to the kits.

HAPPY MODELLING
FROM ALL AT
WHITE ENSIGN MODELS

Unit 5, Cobnash Ind. Estate, Kingsland, Leominster, Herefordshire, HR6 9RW, U.K.

Telephone 0844 415 0914 Fax 0844 415 0916

E.mail: wem@onetel.com

Website: www.WhiteEnsignModels.com