

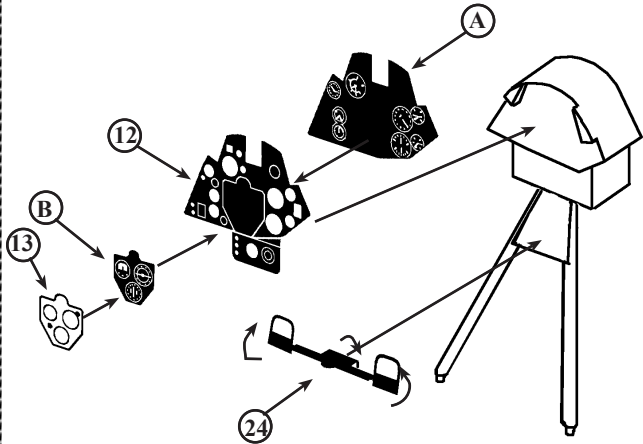

## PILOT'S INSTRUMENT PANEL ASSEMBLY



Assemble the pilot's instrument panel, etched part 12, to kit part 10A, sandwiching the instrument bezel film in between. It is advisable to paint the rear face of the instrument films white, before fitting. Also, fit the small flight instrument cluster, etched part 13, in the same way. Fold the central locating bar on the rudder pedals, etched part 24, to 90°, then fold both pedals up to 90° in the opposite direction. Fit to the lower angled plate on kit part 10A as shown above.

## PILOT'S SEAT ASSEMBLY

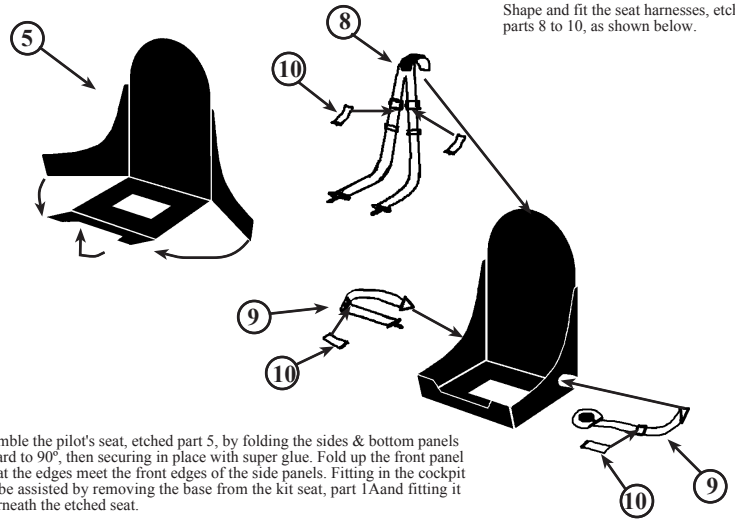

Shape and fit the seat harnesses, etched parts 8 to 10, as shown below.

Assemble the pilot's seat, etched part 5, by folding the sides & bottom panels forward to 90°, then securing in place with super glue. Fold up the front panel so that the edges meet the front edges of the side panels. Fitting in the cockpit may be assisted by removing the base from the kit seat, part 1A and fitting it underneath the etched seat.

## THROTTLE & INSTRUMENT ASSEMBLY

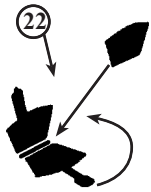

Fold the two parts of the throttle controls, etched parts 22, over until they are parallel, then fit the blank spacer plate in between them. Secure into place.

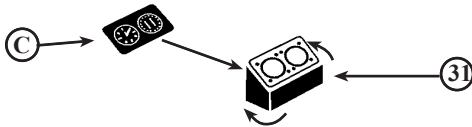

Fold the front panel of etched part 31 down, then fold the side panels to 90° so that they meet up with the top panel as shown above. Secure into place, then fit the instrument film behind the top panel.

## PILOT'S SIDE CONSOLE DETAILS

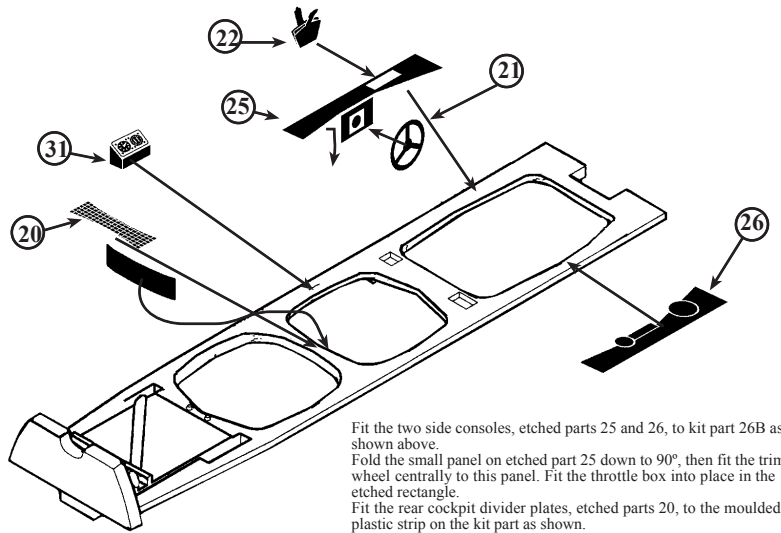

Fit the two side consoles, etched parts 25 and 26, to kit part 26B as shown above.

Fold the small panel on etched part 25 down to 90°, then fit the trim wheel centrally to this panel. Fit the throttle box into place in the etched rectangle.

Fit the rear cockpit divider plates, etched parts 20, to the moulded plastic strip on the kit part as shown.

## OBSERVERS COCKPIT DETAILS

Fold the cockpit bulkhead, etched part 37 in half, so that the relief etched detail is outermost. Fit the small access panels, etched parts 4, over the circular openings in either the open or shut positions. Fit this assembly in place of kit part 3D.

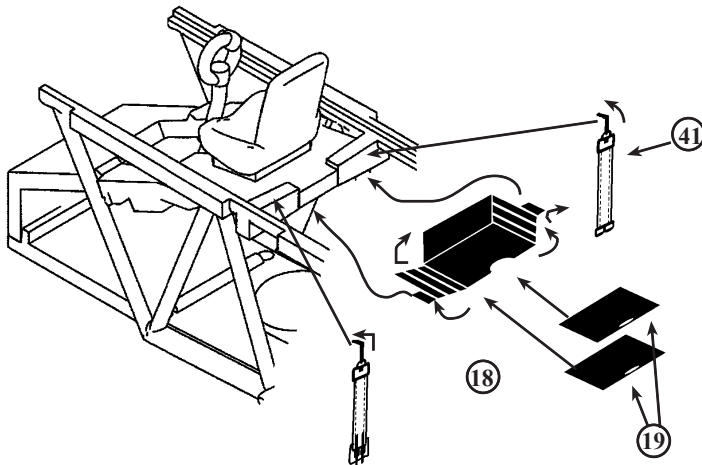
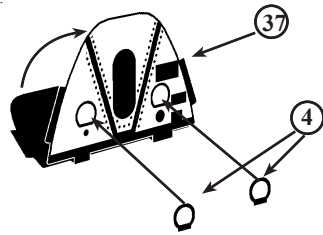

Fold up the sides and rear panels of etched part 18 making sure the relief etched locating lines are inside. Fit the chart table drawers, etched parts 19, inside the etched locating lines. Fit this assembly under the pilot's seat floor panel. Fit the narrow ends of the observers restraining straps, etched parts 41, to each side of the cross bar as shown.

## MACHINE GUN FITTINGS

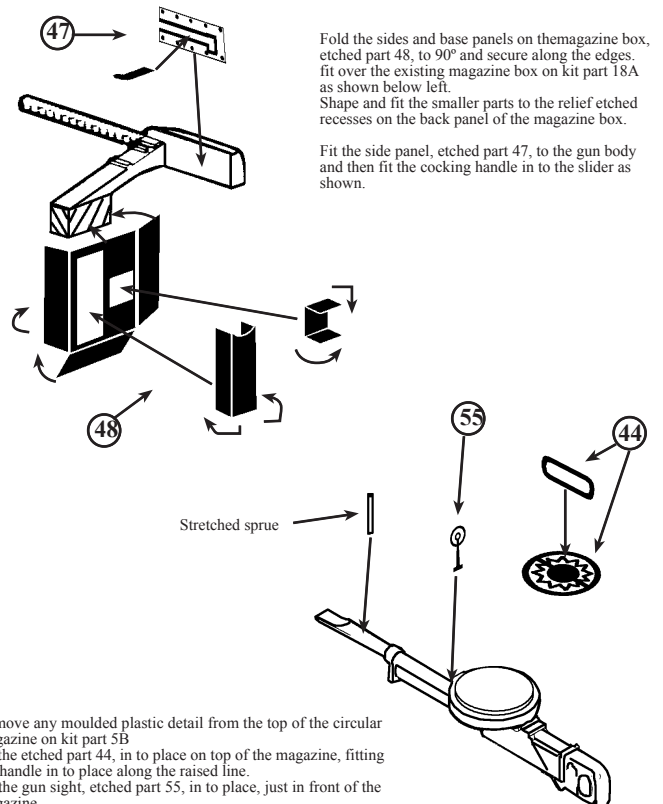

Fold the sides and base panels on the magazine box, etched part 48, to 90° and secure along the edges. Fit over the existing magazine box on kit part 18A as shown below left.

Shape and fit the smaller parts to the relief etched recesses on the back panel of the magazine box.

Fit the side panel, etched part 47, to the gun body and then fit the cocking handle in to the slider as shown.

Remove any moulded plastic detail from the top of the circular magazine on kit part 5B. Fit the etched part 44, in to place on top of the magazine, fitting the handle in to place along the raised line. Fit the gun sight, etched part 55, in to place, just in front of the magazine. Fit a short length of stretched sprue or plastic rod to the top of the gun barrel as a fore sight as shown above right.

### COCKPIT LEFT SIDE DETAILS

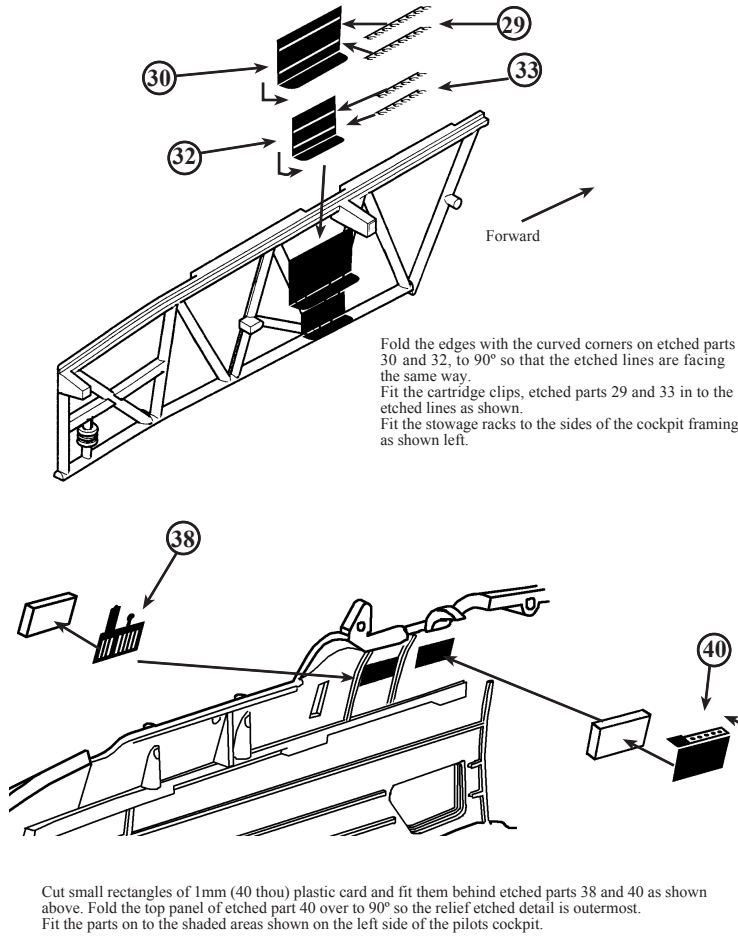

### COCKPIT RIGHT SIDE DETAILS

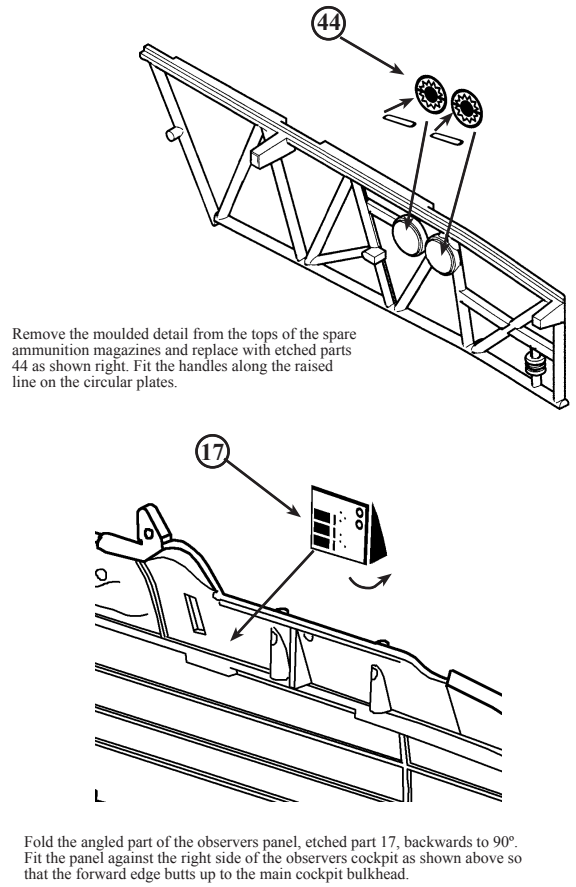

### WIRELESS BOX FACIA DETAILS

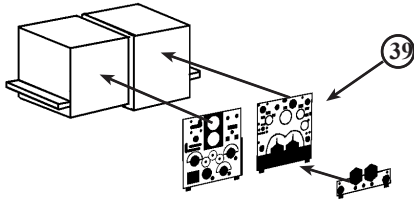

### PILOTS GUN SIGHT LOCATION

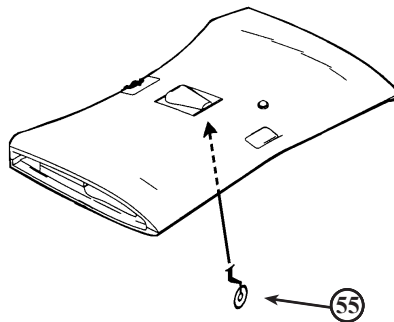

### PILOTS GRAB HANDLES

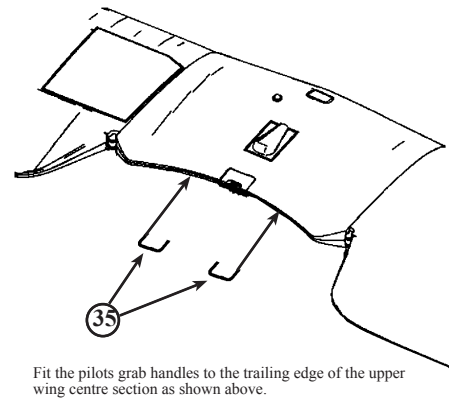

### ENGINE FITTINGS

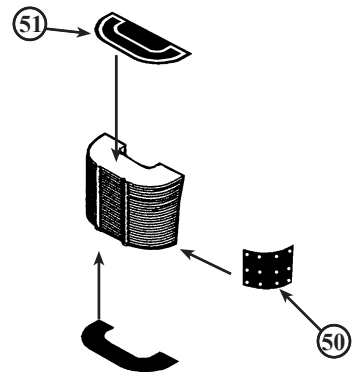
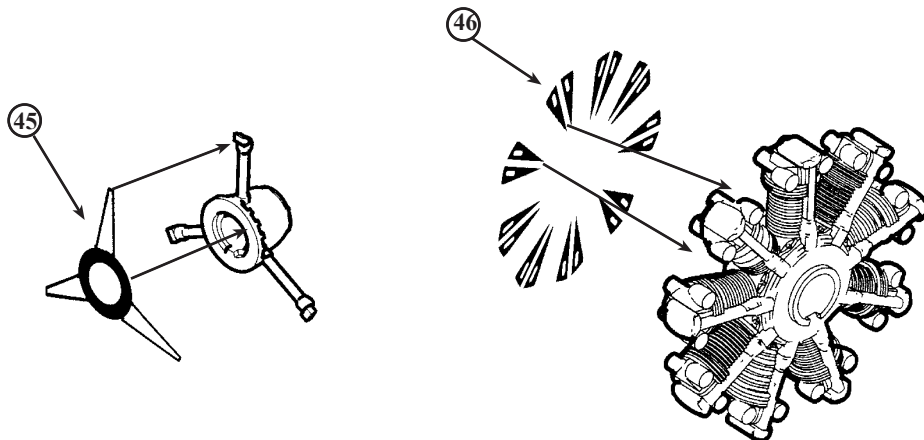

### UPPER WING LEADING EDGE SLAT ASSEMBLY

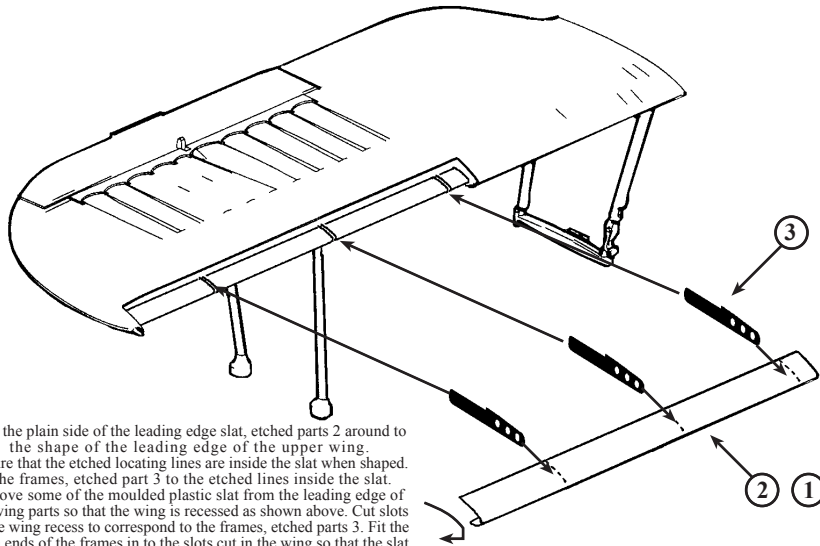

Fold the plain side of the leading edge slat, etched parts 2 around to take the shape of the leading edge of the upper wing. Ensure that the etched locating lines are inside the slat when shaped. Fit the frames, etched part 3 to the etched lines inside the slat. Remove some of the moulded plastic slat from the leading edge of the wing parts so that the wing is recessed as shown above. Cut slots in the wing recess to correspond to the frames, etched parts 3. Fit the plain ends of the frames in to the slots cut in the wing so that the slat is portrayed in the extended position. Repeat on the opposite wing.

### TORPEDO SIGHTING BAR LOCATION

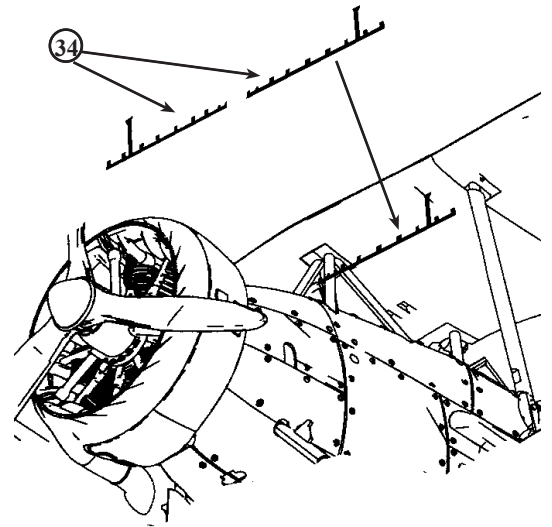

Fit the torpedo sighting bars, etched parts 34, so that the inner ends fit onto the central wing support struts. The foot of the outer end support leg fits onto the underside of the upper wing.

### WING FOLD LATCH HANDLE

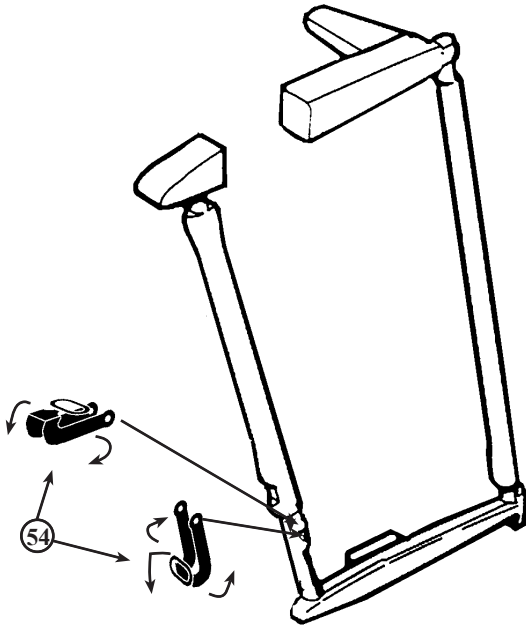

Fold the sides of the latch handles, etched parts 54, to 90° so that they are parallel. Remove the moulded plastic detail from the foot of the inner struts, kit parts 5D and 7D. Fit the latch handles so that they are in the down position when the wings are spread and up when the wings are folded.

### UNDERCARRIAGE FOOT STEP LOCATION

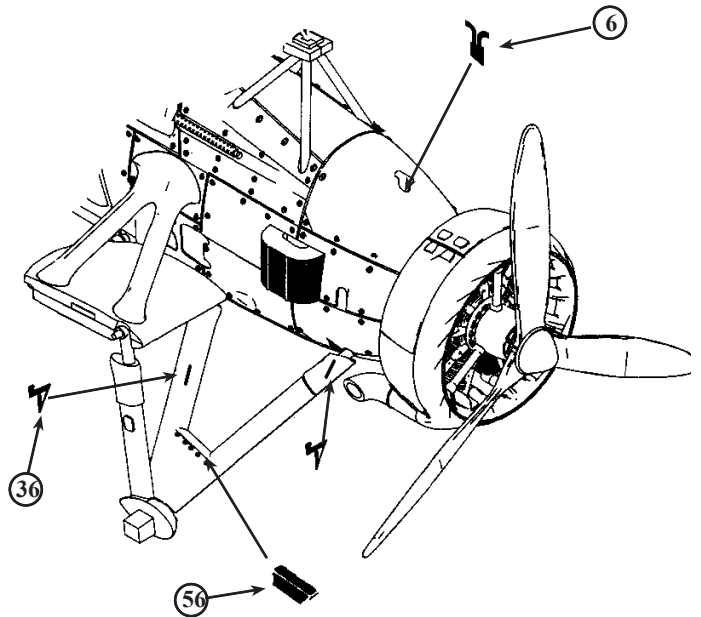

Remove the moulded plastic footsteps from the undercarriage legs and replace them with etched parts 36 and 56 as shown. An alternative breather tube, etched part 6, has been provided to fit if desired, having removed the moulded plastic item first.

### TAIL PLANE FITTINGS

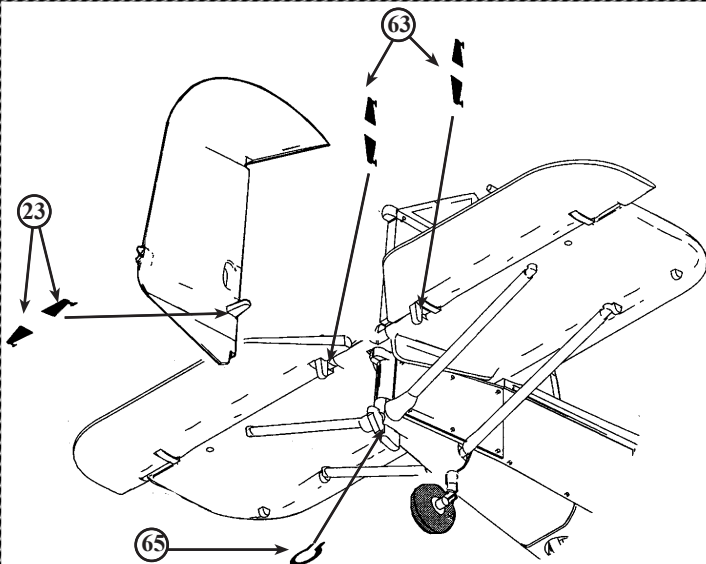

Remove the moulded plastic elevator and rudder control horns and replace using the etched parts 63 and 23 respectively. Fit the tail tie down ring, etched part 65 as shown.

### ASV RADAR ANTENNA LOCATION

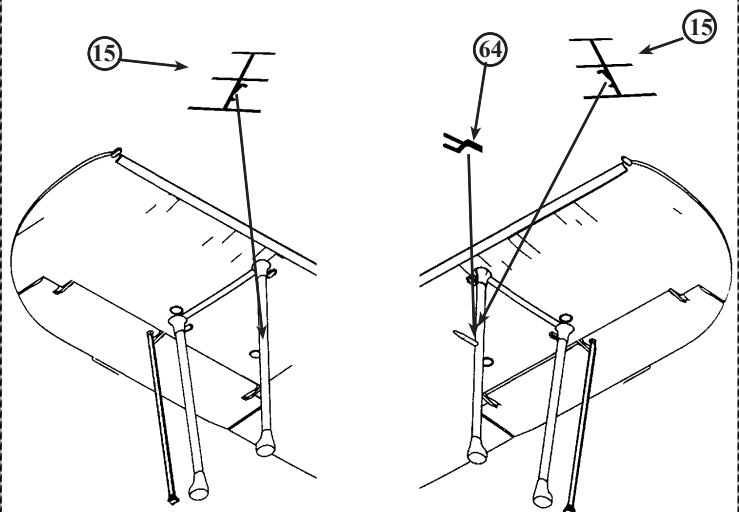

Remove the moulded plastic pitot tube from the left wing outer strut and replace with the etched part 64. The ASV antennas, etched parts 15, have been provided as an optional extra and are fitted to the outer wing front struts as shown. Note that these are angled to point outwards when fitted correctly.

## RIGGING EYE FITTING

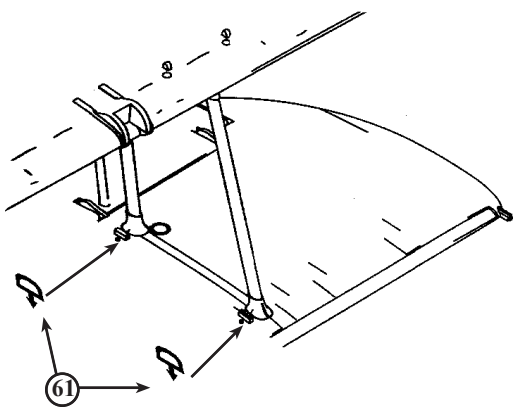

If the model is to be rigged with bracing wires, etched parts 61 will greatly assist you with this process. Drill small holes at the base of each strut, then push the barbed locating stub on the base of each eyelet into the holes. These will be secured in to place by the barbed stud, but an application of super glue may be necessary to fully secure the eyelets in to place. The rigging wire may now be threaded through the eyelets as desired. A fine fly fishing line is recommended for rigging.

## SEAPLANE VERSION FLOAT DETAILS

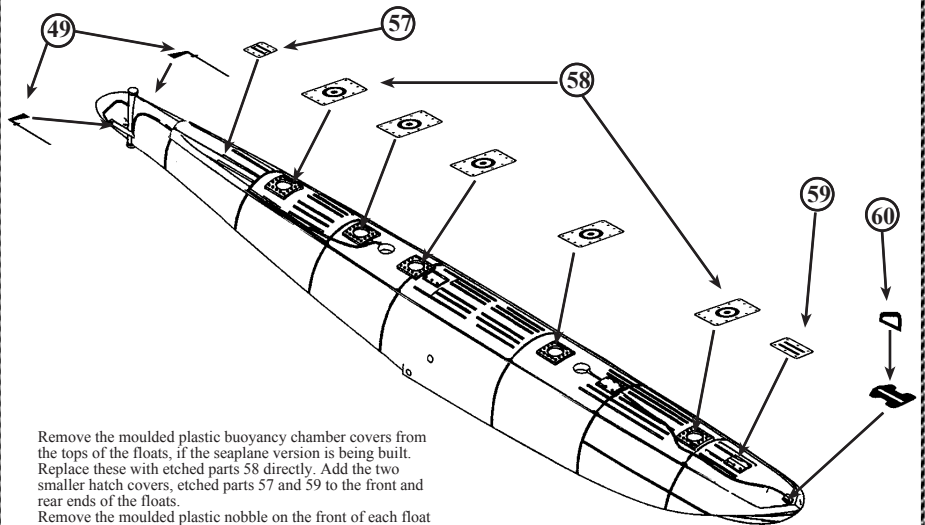

Remove the moulded plastic buoyancy chamber covers from the tops of the floats, if the seaplane version is being built. Replace these with etched parts 58 directly. Add the two smaller hatch covers, etched parts 57 and 59 to the front and rear ends of the floats. Remove the moulded plastic nubble on the front of each float and replace with the grab handles, etched parts 60, as shown. Remove the moulded plastic rudder control horns, and replace with etched parts 49 to each side of the rudders.

## LIGHT SERIES BOMB CARRIER ASSEMBLY

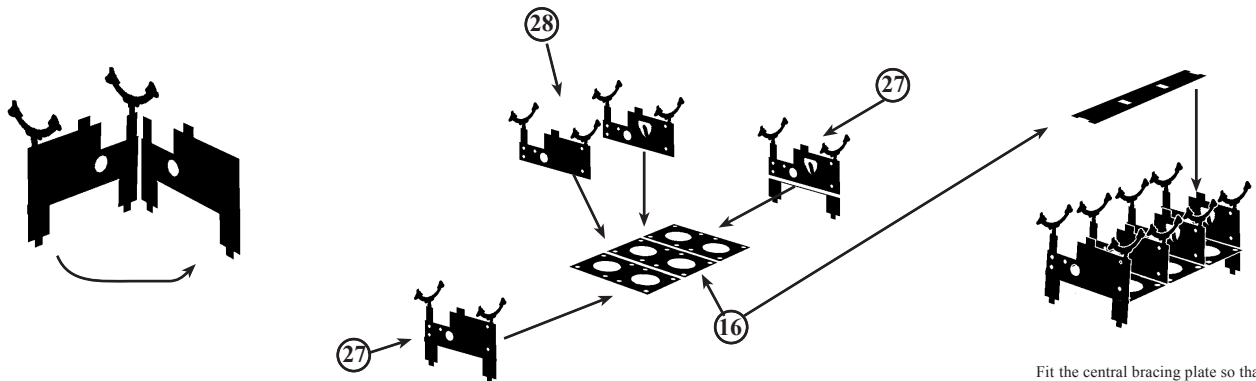

Fold the light bomb carriers, etched part 27 and 28, in half and secure in to place so that the relief etched detail is outer most. Turn the sway braces to 90°.

Fit the centre plate so the shorter edges fit in to the etched lines on the inboard sides of the bomb carriers 27. These carriers have the mounting feet. Fit the bomb carriers 28 to the fore and aft etched lines on the top of the centre plate as shown above.

Fit the central bracing plate so that the holes fit over the lugs on the two inner carriers. The end forks then fit around the lugs on the outer carriers. These assemblies directly replace kit parts 8A and 9A.

## 250lb BOMB AND BOMB CARRIER DETAIL

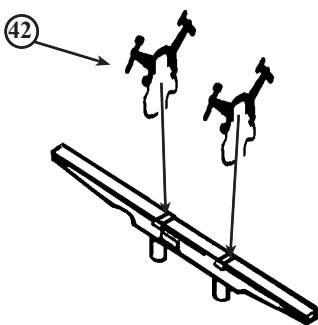

Remove the moulded plastic sway braces from the bomb carriers, kit parts 18C, and replace with etched parts 42 as shown above.

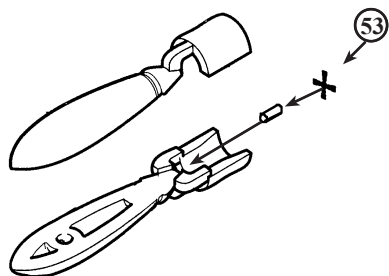

Fit the bomb arming vanes to each of the bombs by attaching etched parts 53 to a short length of stretched sprue and fitting in to the rear of each bomb as shown above.

## OTHER INSTRUCTIONS

1. Wiring Loom, etched part 14, has been supplied to fit to the pilots control stick so that the curved end is at the top and located to the back of the firing button.
2. Etched part 62 has been provided as an extra piece of detail for the forward gun if desired. This may be rolled in to a cylinder shape and fitted over the existing gun barrel of kit part 18A.
3. Etched Part 52 may be used to replace the crew entry footstep, kit part 16B, if it is found necessary.
4. Kit parts 3B and 4B may be directly replaced using etched parts 43, if it is found that the kit parts are too heavy when building the model with wings spread for flight. Curve the spigot at the point of the V to form a hook in the manner of the kit parts.
5. Etched part 11, is a compass bezel that can be given depth by backing up with 30 thou (0.75mm) plastic card. This compass could be fitted to attachment points on the rear cockpit edging.
6. Recommended publications for further research in to the Swordfish are the fine Warpaint No12 Fairey Swordfish by W.A. Harrison. Also Swordfish -From the Cockpit by Donald Payne gives a good photographic record as well as many interesting accounts given by those who flew in them.