

# WHITE ENSIGN MODELS

## USN Gato-Class Fleet Submarine

### Radar and Wireless Antennas

Photoetched Metal Detail set for the Revell Kit in 1/72 scale

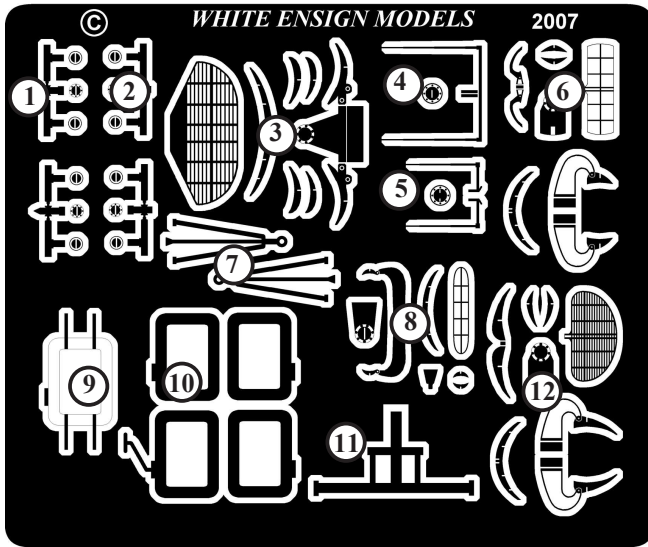

#### PARTS LIST

1. DBU Antenna (Point Top)
2. DBU Antenna (Flat Top)
3. SV Radar Antenna Assembly
4. SD Radar Antenna (Early)
5. SD Radar Antenna (Late)
6. SJ Radar Antenna Assembly (Early)
7. Wire Antenna Spreaders
8. SS Radar Antenna Assembly
9. Rectangular DF Antenna Front Panel
10. Rectangular DF Antenna Plates
11. Rectangular DF Antenna Mounting Frame
12. SJ Radar Antenna Assembly (Late)

#### SD ANTENNA ASSEMBLY

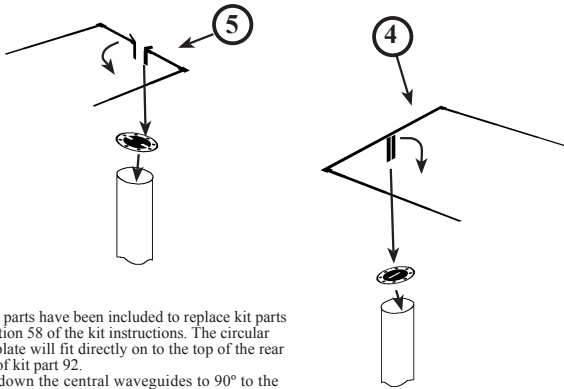

These parts have been included to replace kit parts in section 58 of the kit instructions. The circular base plate will fit directly on to the top of the rear mast of kit part 92. Fold down the central waveguides to 90° to the crossbar. Locate & secure the base of the wave guides to the circular base plate.

#### RECTANGULAR DF LOOP ANTENNA ASSEMBLY

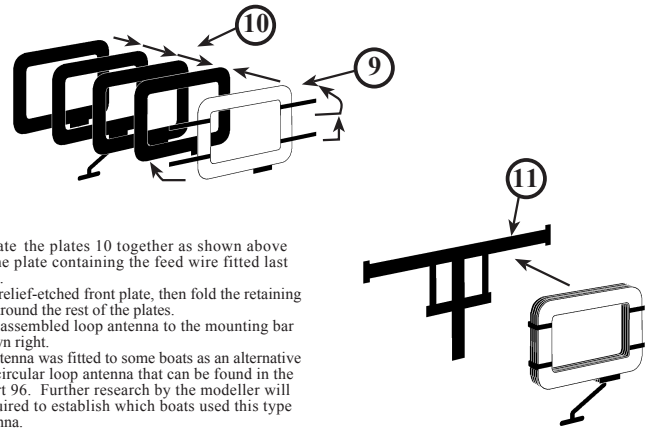

Laminate the plates 10 together as shown above with the plate containing the feed wire fitted last but one. Fit the relief-etched front plate, then fold the retaining straps around the rest of the plates. Fit the assembled loop antenna to the mounting bar as shown right. This antenna was fitted to some boats as an alternative to the circular loop antenna that can be found in the kit, part 96. Further research by the modeller will be required to establish which boats used this type of antenna.

#### SJ RADAR ANTENNA ASSEMBLY (EARLY)

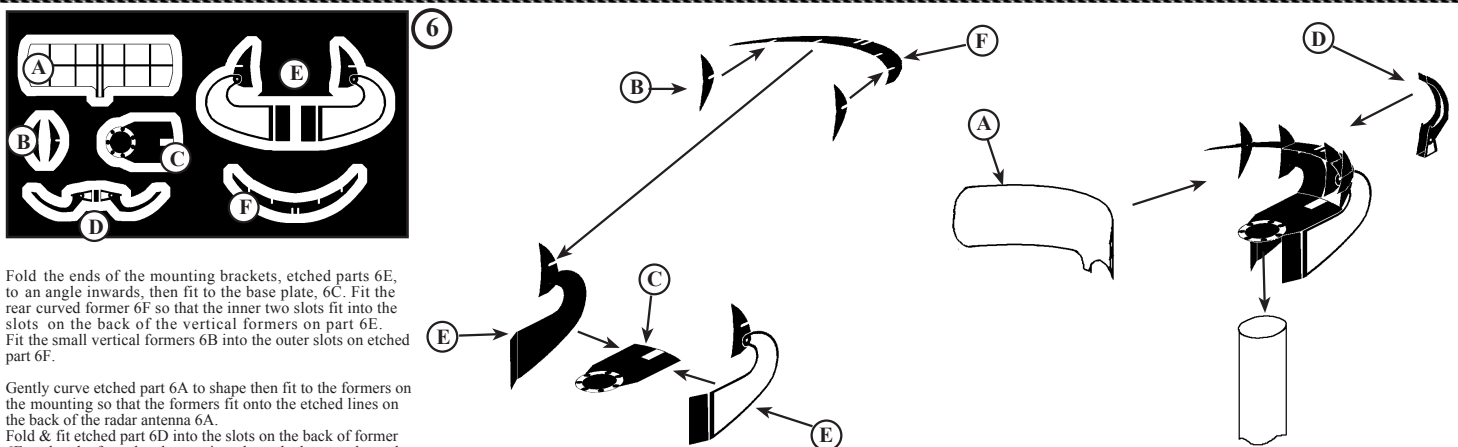

Fold the ends of the mounting brackets, etched parts 6E, to an angle inwards, then fit to the base plate, 6C. Fit the rear curved former 6F so that the inner two slots fit into the slots on the back of the vertical formers on part 6E. Fit the small vertical formers 6B into the outer slots on etched part 6F.

Gently curve etched part 6A to shape then fit to the formers on the mounting so that the formers fit onto the etched lines on the back of the radar antenna 6A. Fold & fit etched part 6D into the slots on the back of former 6F so that the foot plate locates into the etched rectangle on the base plate part 6C. The tops of the two forks locate to the top of the rear face of the antenna part 6A. This assembly can be used as an alternative to kit part 100, & was fitted to a lot of earlier boats.

### SJ-1 RADAR ANTENNA ASSEMBLY (LATE)

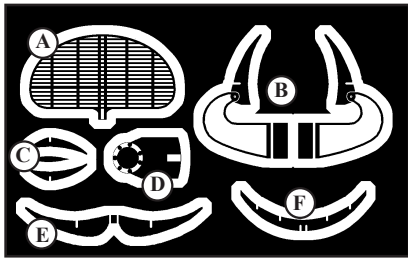

Fold the ends of the mounting brackets, etched parts 12B, to an angle inwards, then fit to the base plate, 12D. Fit the rear curved former 12F so that the inner two slots fit into the slots on the back of the vertical formers on part 12B. Fit the small vertical formers 12C into the outer slots on etched part 12F.

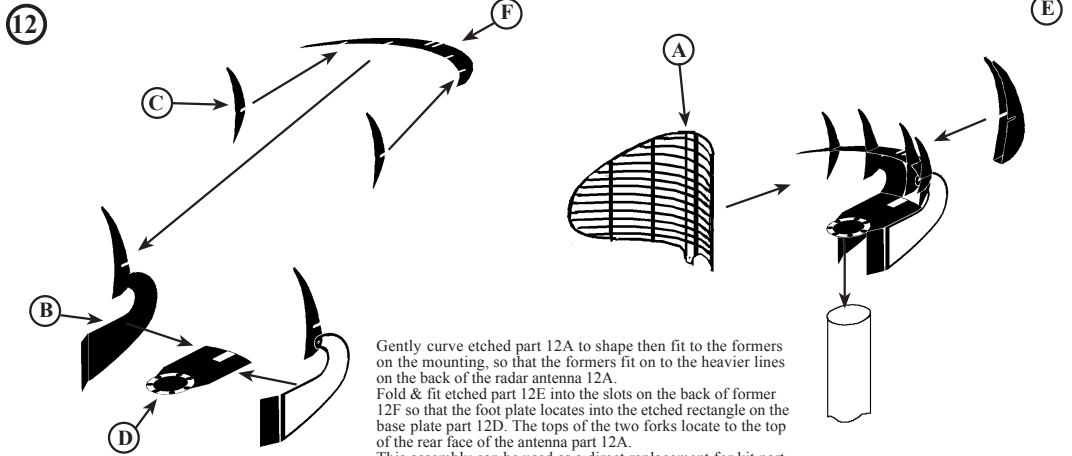

Gently curve etched part 12A to shape then fit to the formers on the mounting, so that the formers fit on to the heavier lines on the back of the radar antenna 12A. Fold & fit etched part 12E into the slots on the back of former 12F so that the foot plate locates into the etched rectangle on the base plate part 12D. The tops of the two forks locate to the top of the rear face of the antenna part 12A. This assembly can be used as a direct replacement for kit part 100, & was fitted to later-fit boats.

### SV RADAR ANTENNA ASSEMBLY

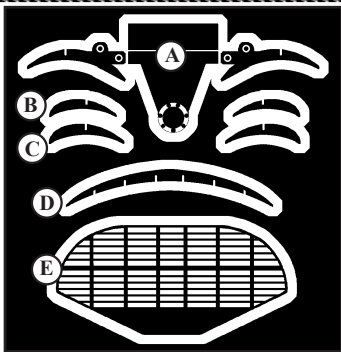

Fold up the sides & back plate of etched part 3A to 90° so that the relief etching appears outermost. Fit the horizontal former, part 3D, so that the second & fifth slots locate into the slots on the rear of the formers of etched part 3A. Fit the vertical formers 3B & 3C to the slots on the former 3D as shown & secure in place.

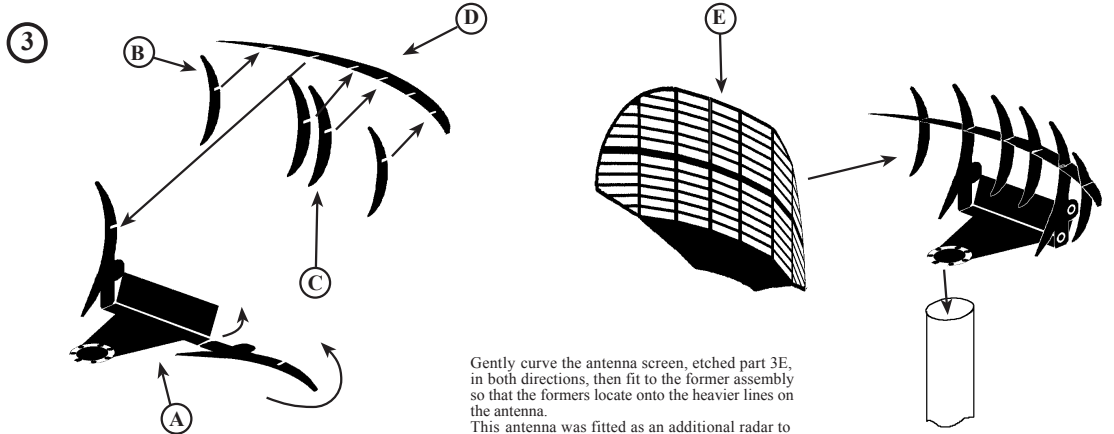

Gently curve the antenna screen, etched part 3E, in both directions, then fit to the former assembly so that the formers locate onto the heavier lines on the antenna. This antenna was fitted as an additional radar to some boats late- or post-war. Further research will be required by the modeller as to which boats had these & where they were fitted.

### SS RADAR ANTENNA ASSEMBLY

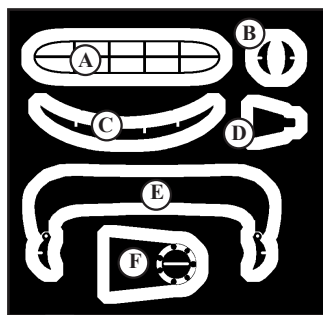

The SS radar was a later alternative to the SJ radar. The antenna was fitted in the place of the SJ antenna on the same mast. Assembly for this follows a similar form to that of the previous radar antennas, & as such further research will be required to find out which boats were fitted with them & at what time period.

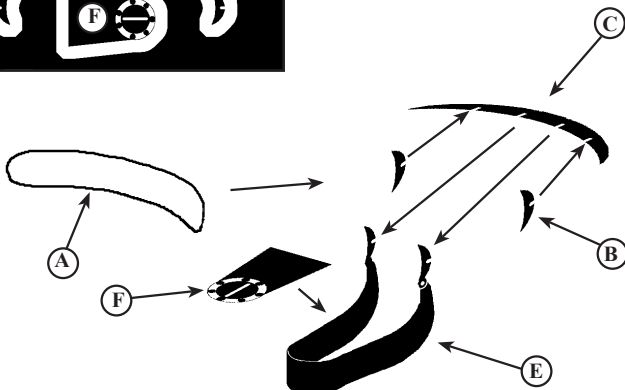

### DBU DETECTION ANTENNA

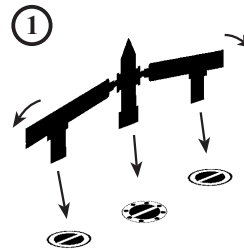

Later in the war a radar detection device was fitted to the submarines so that they could tell if there were any radar transmissions in the area. This antenna was for the most part fitted to each side of the conning tower. The part can be shaped as shown left by bending the arms downwards & then trimming the outer feet to length before fitting the circular base plates.

### WIRE ANTENNA SPREADERS

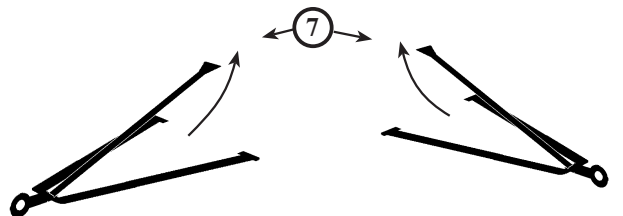

The kit provided wire antenna spreaders in the form of parts 84, but this set provides an alternative type that can be fitted if desired in direct replacement. These etched parts are shaped as shown above & fitted so that the stay is uppermost.