

WHITE ENSIGN MODELS

USN Elco PT Boat
Photoetched detail set in two parts to fit the
Revell 1/72 scale kit

PARTS LIST

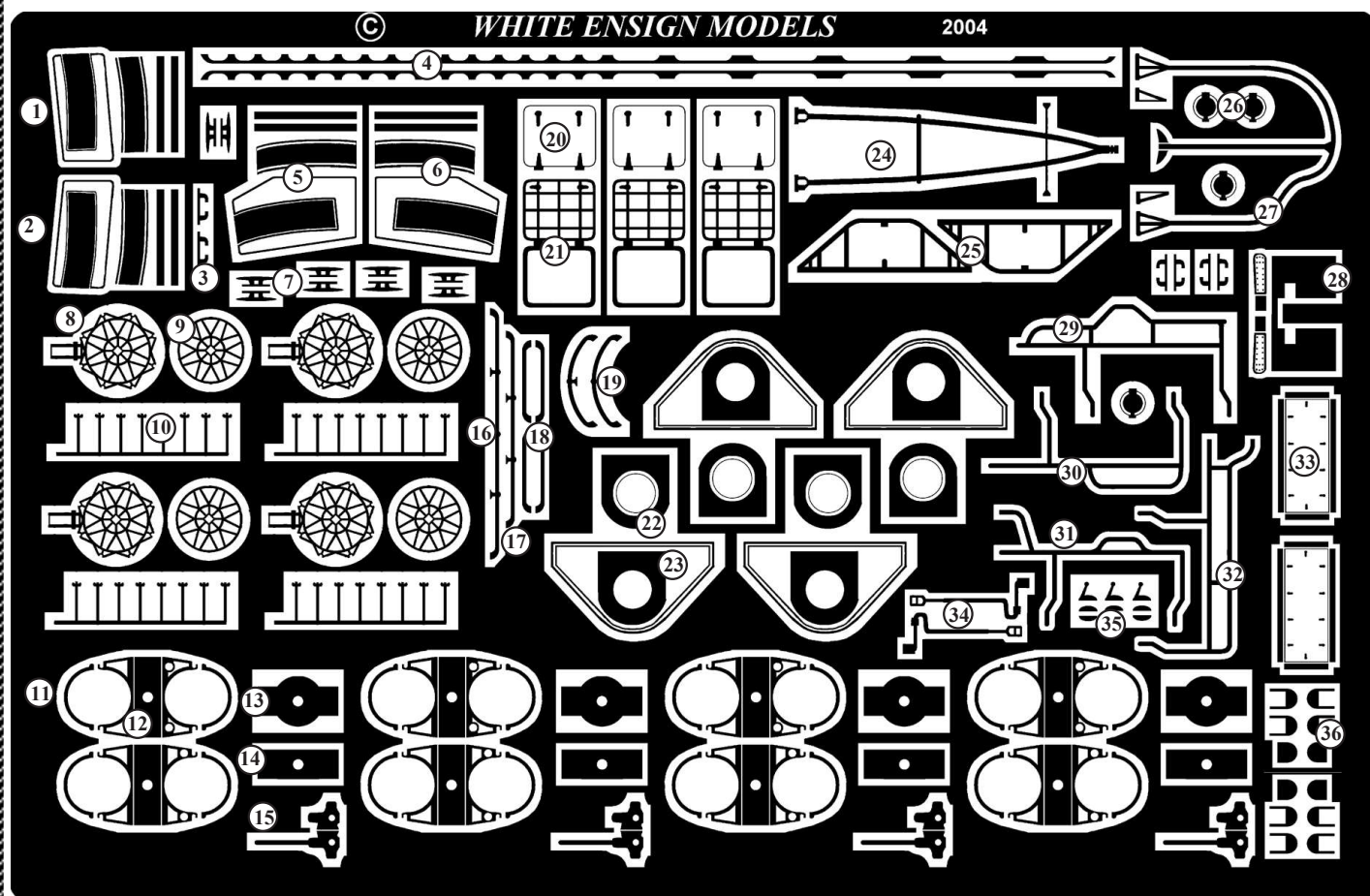

1. Torpedo Tube Trainer Plate (Port Front)
2. Torpedo Tube Trainer Plate (Starboard Front)
3. Open Chocks/Fairleads
4. Foot Rails
5. Torpedo Tube Trainer Plate (Port Aft)
6. Torpedo Tube Trainer Plate (Starboard Aft)
7. Cleats
8. Torpedo Tube Breach Plate
9. Torpedo Tube Breach Stiffeners
10. Torpedo Tube Breach Securing Bars
11. Torpedo Tube Clamp Ring (Upper)
12. Torpedo Tube Clamp Ring (Lower)
13. Clamp Plate (Aft)
14. Clamp Plate (Forward)
15. Tube Training Crank Linkage
16. Cabin Roof Hand Rail (Starboard)
17. Cabin Roof Hand Rail (Port)
18. Short Grab Rails

19. Curved Grab Rails
20. Deck Hatch Outer Detail
21. Deck Hatch Inner Detail & Coaming
22. Torpedo Tube Hinge Deck Plate Riser
23. Torpedo Tube Hinge Deck Plate
24. Mast
25. .50 cal Machine Gun Mounting Frame
26. Fuel Filler Caps
27. 20mm Oerlikon Depression Rail
28. 20mm Oerlikon Shield
29. .50 cal Machine Gun Depression Rail (Kit Part 45)
30. .50 cal Machine Gun Depression Rail (Kit Part 46)
31. .50 cal Machine Gun Depression Rail (Kit Part 43)
32. .50 cal Machine Gun Depression Rail (Kit Part 44)
33. 20mm Ready-use Locker Covers
34. Torpedo Tube Training Crank Handles
35. Throttle Quadrant Parts
36. 'D' Vent Assemblies

PARTS LIST

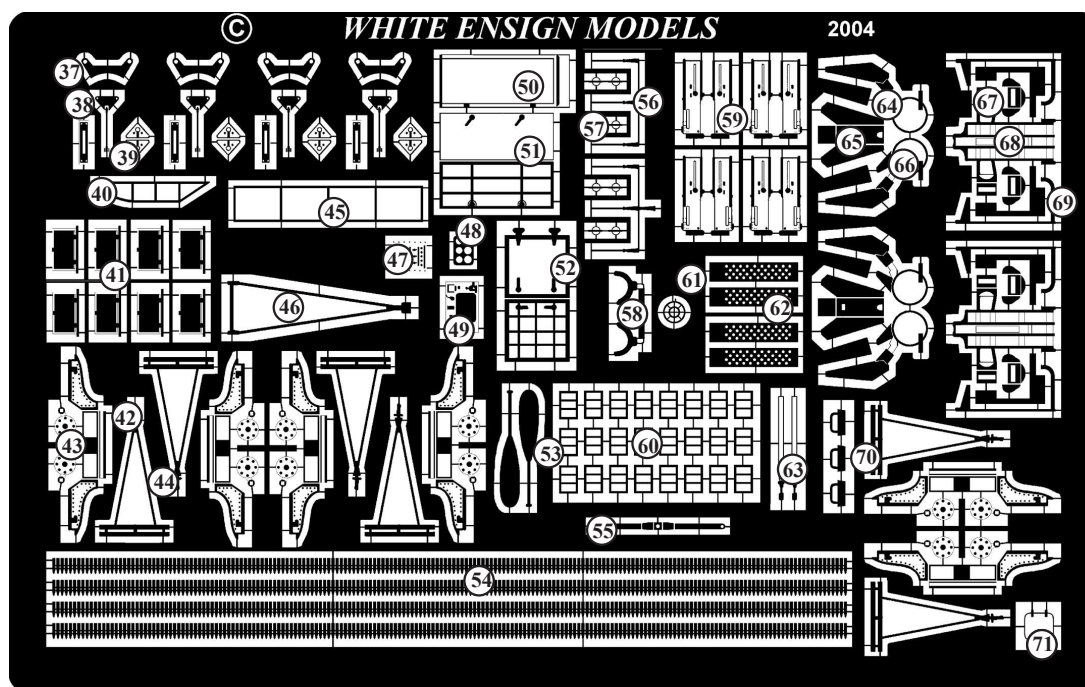

- | | |
|---------------------------------------|--|
| 37. Torpedo Tube Limit Stop Plate | 55. Searchlight Bracket |
| 38. Torpedo Tube Front Cover Plate | 56. Exhaust Muffler Linkages |
| 39. Torpedo Tube Limit Stop | 57. Exhaust Muffler Butterfly Valves |
| 40. Windshield Frame Port Side | 58. 20mm Oerlikon Shoulder Braces |
| 41. Chart House & Cabin Window Covers | 59. .50 cal. Machine Gun Breech Details |
| 42. Depth Charge Rack | 60. Deadlight Frames |
| 43. Depth Charge Trigger Plate | 61. 20mm Oerlikon Ring Sight |
| 44. Depth Charge Retaining Harness | 62. .50 cal. Machine Gun Barrel Perforated Jackets |
| 45. Windshield Frame | 63. Smoke Generator Straps |
| 46. Mast Brace | 64. .50 cal. Machine Gun Mounting Pintle (Left) |
| 47. Torpedo Control Panel | 65. .50 cal. Machine Gun Mounting Pintle Bracket |
| 48. Engine Gauge Panel | 66. .50 cal. Machine Gun Mounting Pintle (Right) |
| 49. General Control Panel | 67. .50 cal. Machine Gun Ammunition Feed Plate |
| 50. Chart House Door Frame | 68. .50 cal. Machine Gun Mounting Cradle |
| 51. Chart House Door | 69. .50 cal. Machine Gun Trigger Bar |
| 52. Cabin Roof Hatch | 70. Cover Handles |
| 53. Rubber Boat Paddles | 71. Bow Deck Hatch |
| 54. .50 cal. Ammunition Belts | |

General Instructions

1. Do not remove the etched parts from the fret until you are ready to use them.
2. Before assembly, soak the etched parts in a suitable solvent, such as white spirit, to de-grease the surfaces for painting.
3. Cyanoacrylate adhesive (super glue) or contact adhesive such as Elmers white glue may be used. These can be applied with a pin or piece of stretched sprue.
4. When removing parts from the fret, place the fret on a hard surface, such as a smooth ceramic tile, in order to prevent parts bending whilst cutting through the holding tabs. We suggest using a #11 type of modelling knife blade for this purpose.
5. When shaping or bending a part, a straight edged blade such as a chisel blade #17 or # 18 will give a good sharp corner , or alternatively a small pair of smooth jawed pliers may be used.
6. If a part is bent incorrectly, lay it on a hard flat surface & roll it flat with a cylindrical object such as a modelling knife handle.
7. We suggest that rails are pre-measured, where practical, using a pair of compass dividers & then tacked to the deck edge every third or fourth stanchion with a s mall drop of glue. When a section is complete,run a thin line of glue along the inside edge to attach it firmly to the deck.

.50 CAL. MACHINE GUN DETAILING

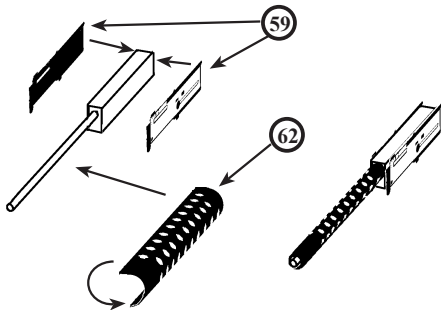

The .50-calibre machine guns provided in the kit, parts 29, can be separated & cleaned of detail before adding the etched metal details as shown above. The air cooling sleeve etched part 62, needs to be rolled around a piece of metal rod until the cylindrical shape is achieved.

.50 CAL. MG MOUNTING CRADLE

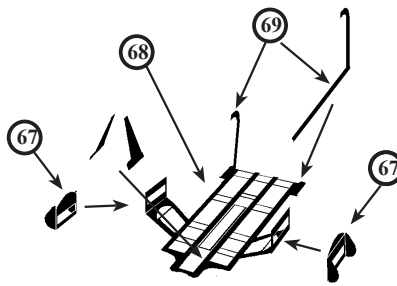

Assemble the .50-calibre machine gun mounting cradle by bending up the ammunition guides on each side as shown. Fold & fit the ammo belt feed plates, 67, to each of the guide arms. Remove the forward triangular parts of the trigger bars & fit to the centre area as shown, joining them at the top.

MOUNTING PINTLE

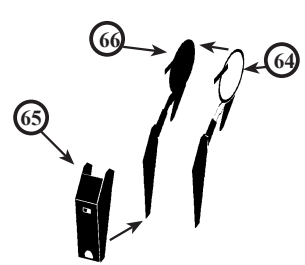

Join the two halves of the mounting pintle, 64 & 66, together so that the etched detail is outer most. Fit the completed pintle into the centre of the attachment bracket, 65, after first folding this into shape as shown.

.50 CAL. MOUNT ASSEMBLY

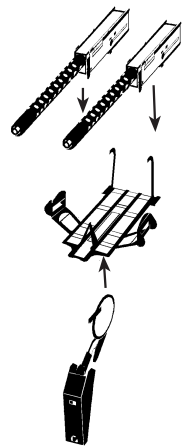

Fit together the completed sub-assemblies as shown above. The circular elevation wheel on top of the mounting pintle fits into the slot in the centre of the cradle assembly, so that it protrudes halfway up.

.50 CAL. SCARF RING ATTACHMENT

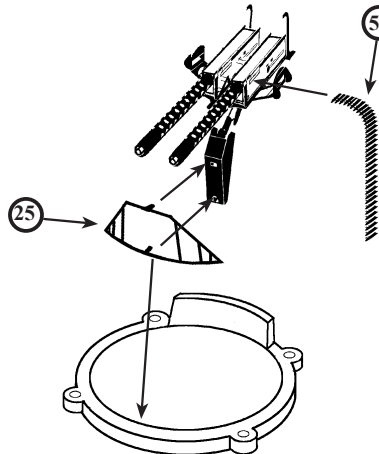

Curve etched part 25 & fit around the front of kit parts 21. This replaces the plastic kit parts 28. Fold the central lugs to the rear so that the mounting pintle bracket fits onto them. Cut lengths of ammunition belt & fold them through the guides on each side of the mount.

20mm OERLIKON DETAILS

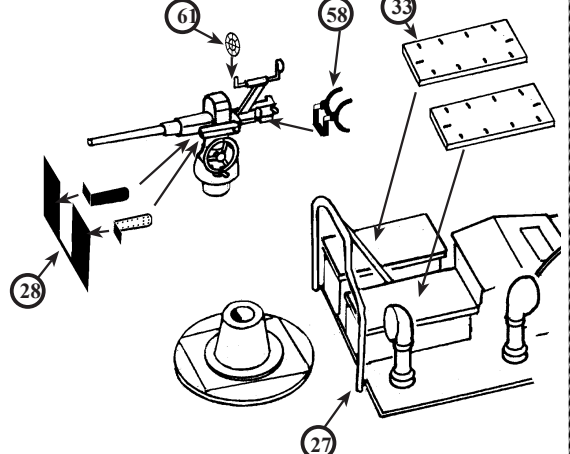

A shield has been provided for the 20mm, which is assembled & fitted as shown above. Fold the shoulder braces, etched part 58, so that they are parallel & fit to the rear of the gun body. Cut down the stem on the gun sight & fit the ring sight, etched part 61, in its place. An alternative depression rail, etched part 27, has been provided for fitting if desired. Fold down the sides & ends of the ammunition box tops, etched parts 33, & fit in place of kit parts 36.

TORPEDO TUBE DECK PLATE ASSEMBLY

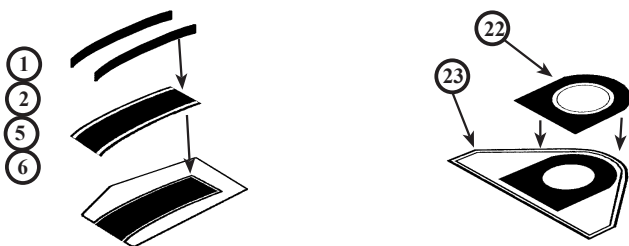

Assemble the torpedo tube mounting plates as shown above, then, using a sharp knife, remove the moulded plastic details from the deck of the kit part. Remove only the surface detail, leave the plastic impressions of the mounting plates in place to provide a base on which to locate the etched metal parts. Fit the assembled etched metal plates in place using the parts list as a positional location guide for each one.

TORPEDO TUBE BREECH ASSEMBLY

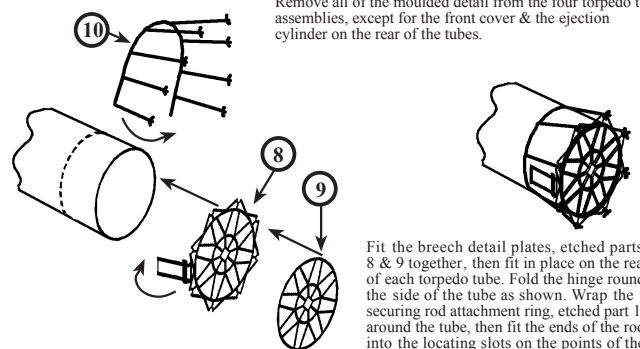

Remove all of the moulded detail from the four torpedo tube assemblies, except for the front cover & the ejection cylinder on the rear of the tubes.

Fit the breech detail plates, etched parts 8 & 9 together, then fit in place on the rear of each torpedo tube. Fold the hinge round the side of the tube as shown. Wrap the securing rod attachment ring, etched part 10, around the tube, then fit the ends of the rods into the locating slots on the points of the breech plates, as shown above.

MOUNTING CLAMP ASSEMBLY

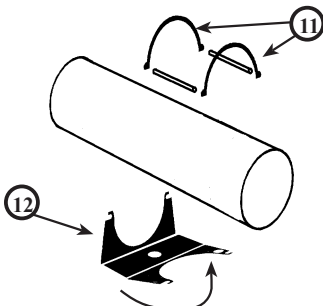

Fold the lower part of the torpedo tube retaining clamp, etched part 12, as shown. Cut 2 lengths of plastic rod & fit them into the hooks of the lower clamp parts. Fit the upper clamp rings over the torpedo tube & locate on each side of the lower clamps & plastic rods. Repeat operation twice on each tube.

TORPEDO TUBE LOCATION AND FIXING

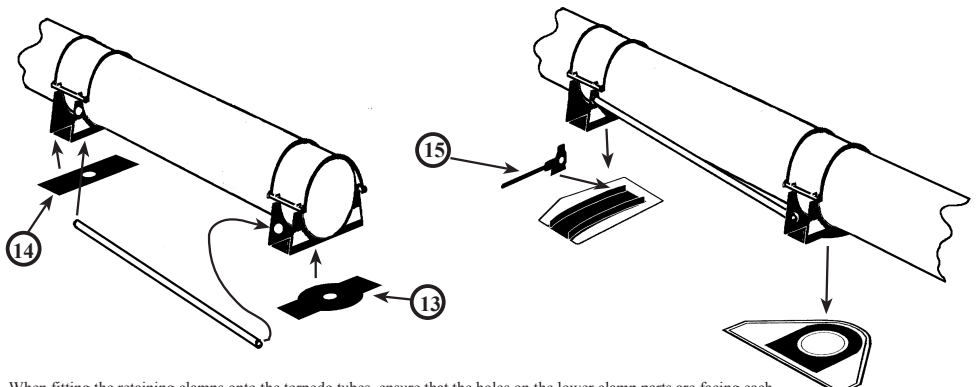

When fitting the retaining clamps onto the torpedo tubes, ensure that the holes on the lower clamp parts are facing each other with the higher holes on the front clamp, lower holes on aft clamp. Cut two 35mm lengths of 1mm (40 thou) plastic rod & fit them into the holes so that they act as spacers between the front & rear clamps. Repeat this on each torpedo tube.

TRAINING STOP ASSEMBLY

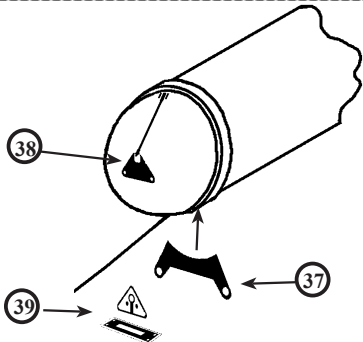

Fit the cover retaining plate, etched part 38 to all torpedo tubes as shown above. Fold the limit stop, part 39 in half so that the etched detail is outermost, then fit into the etched slot in its base. Fit the stop to the deck just below the rim of the torpedo tube cover. Fit the limit stop plate, part 37 to the underside of the rim of the torpedo tube.

DEPTH CHARGE RACK

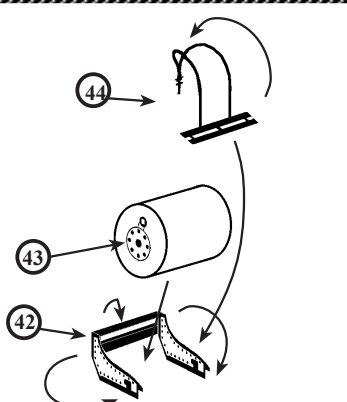

Depth charge racks were fitted to some PT boats. Further research is recommended for location of racks.

DOORS AND HATCHES

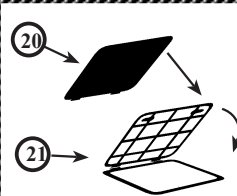

Replacement doors & hatches have been provided in this set. To fit them, the moulded plastic ones must first be removed from the kit parts. Fold the hatches as shown left, then glue the doubler to the top of the hatch. This will then give interior and exterior detail in relief etc.

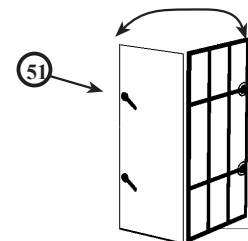

The chart house door is merely folded in two & glued back-to-back so that the relief-etched detail can be seen on both sides.

CHART HOUSE DOOR

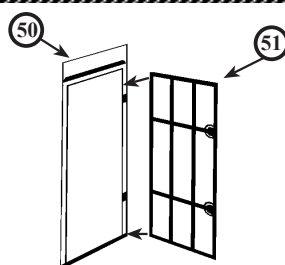

The chart house door area, next to the control console, will need to be removed to fit the etched door frame, part 50 in place. When the door frame has been fitted, the chart house door may be fitted in the open or closed position as desired.

THROTTLE QUADRANT

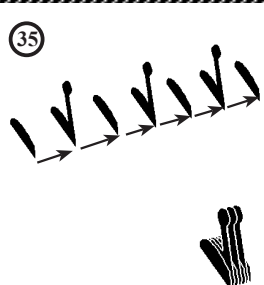

Laminate all of the sections of the throttle quadrant together & secure with glue as shown above.

CONTROL CONSOLE ASSEMBLY

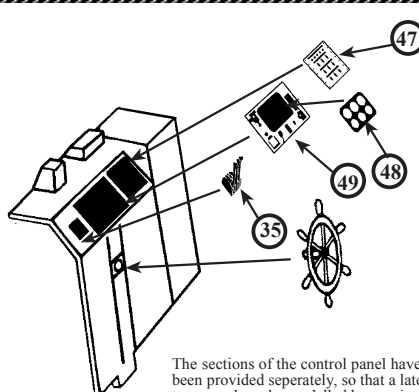

The sections of the control panel have been provided separately, so that a late-type panel can be modelled by moving the sections around, after further research as to their location.

SEARCHLIGHT FITTING

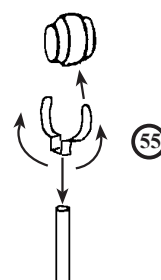

Separate the searchlight from the pole of kit part 32 & shape & fit the swivel bracket, etched part 55, into position as shown above.

COCKPIT EXTERIOR FITTINGS

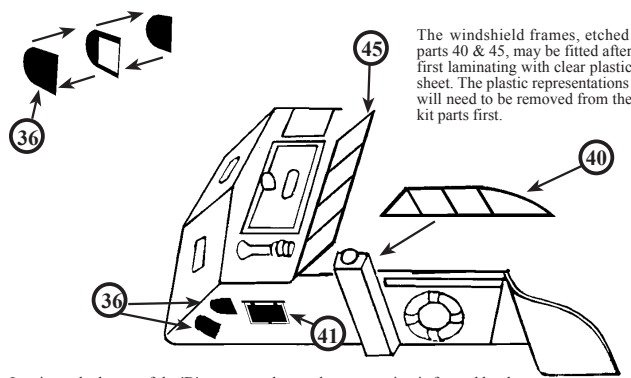

The windshield frames, etched parts 40 & 45, may be fitted after first laminating with clear plastic sheet. The plastic representations will need to be removed from the kit parts first.

Laminate the layers of the 'D' vents together so that an opening is formed by the relief-etched parts fitting together. Fit the vents into position as shown on both sides of the chart house. Fit the chart house window covers, etched parts 41, to both sides of the chart house.

EXHAUST MUFFLER FITTINGS

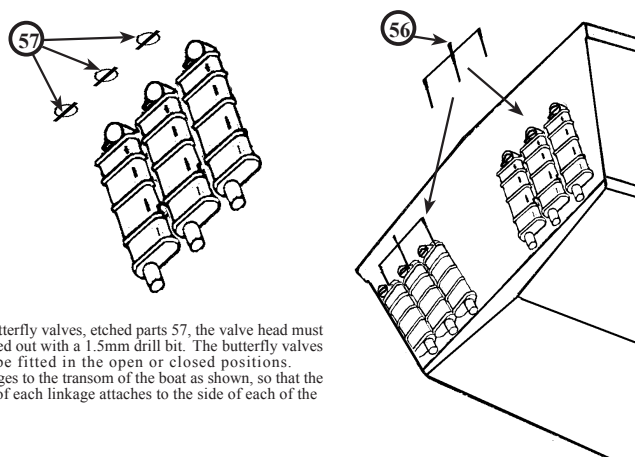

To fit the butterfly valves, etched parts 57, the valve head must first be drilled out with a 1.5mm drill bit. The butterfly valves may then be fitted in the open or closed positions. Fit the linkages to the transom of the boat as shown, so that the lower ends of each linkage attaches to the side of each of the valve heads.

OTHER INSTRUCTIONS

1. This detail provides sufficient parts to replace all the moulded-on deck details on the kit part. This is because of an error in the manufacture of the kit that has given it a heavy planked deck. In reality these decks were close-planked. Some modellers will wish to remove these plank details from the deck for accuracy, and in doing so will need to remove the other details. Note the positions of such items as deadlights, etched parts 60, & fuel caps, etc. before removing the surface details.
2. Etched mast parts 24 & 46 have been provided to replace the kit parts 49 & 50 if it is desired to do so. The .50-calibre machine gun depression rails, kit parts 43, 44, 45 & 46 have also been provided with etched metal replacements. These will require to be shaped with a gentle curve before fitting. Use kit parts as a guide as to the extent of curve required.
3. The moulded footrails on the foc'sle area may be removed & replaced with the etched items 4. Note that the closer spacing of the supports is to aft when fitting.
4. Cabin window covers, etched parts 41 have been provided to fit over the voids on the kit parts.
5. Fairleads or chocks, etched parts 3, & cleats, etched parts 7, have been provided to finish the deck edge area more accurately. Further research will be required to establish the exact location of these items.
6. Hand rails, etched parts 16, 17 & 18 are supplied to fit in place of the moulded items on kit part 20, cabin roof & on the chart house roof. These items are sized to replace a similar-sized item. Etched parts 19 are the grab rails that fit on the outboard face of the circular .50-calibre gun tubs. These are fitted 5mm below the rim of the tub before fitting kit parts 21.