

WHITE ENSIGN MODELS

RN Roma 1943

Photoetched metal detail set for the 1/350 scale Trumpeter kit.



PARTS LIST (Part A)

© WHITE ENSIGN MODELS 2014

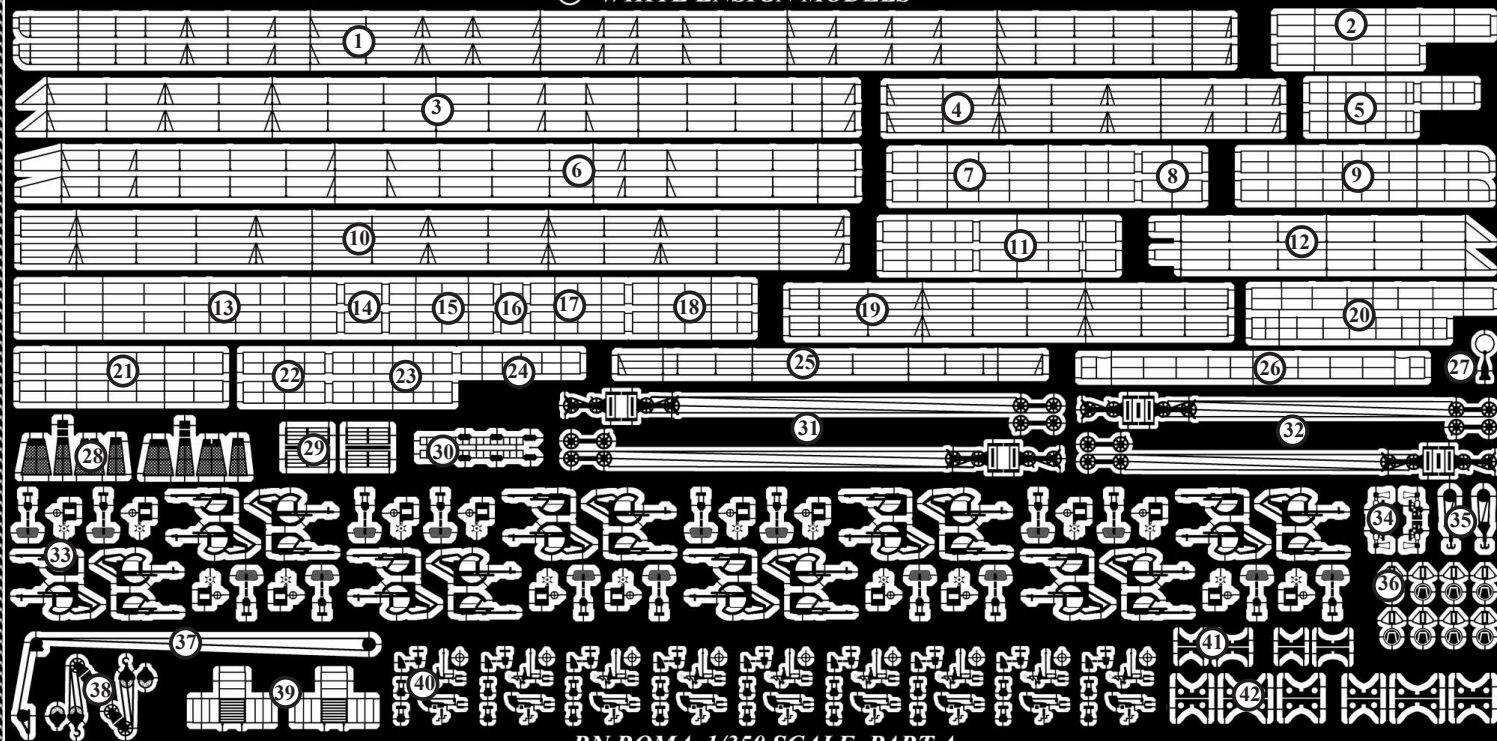

RN ROMA 1/350 SCALE PART A

- | | | |
|--|---|--------------------------------------|
| 1. Railings (Quarterdeck) | 15. Railings (Lower Superstructure) | 29. Breakwater Ladders |
| 2. Railings (Admiral's Bridge E17) | 16. Railings (Lower Superstructure) | 30. Foremast Top Light Array |
| 3. Railings (Foc'sle Sections) | 17. Railings (Lower Superstructure) | 31. Boat Crane Rigging (Boom Stowed) |
| 4. Railings (Main Deck Aft) | 18. Railings (Lower Superstructure) | 32. Boat Crane Rigging (Boom Raised) |
| 5. Railings (Foremast Starfish) | 19. Railings (Secondary Gun Deck Forward) | 33. Breda 20mm Twin Gun Mount |
| 6. Railings (Main Deck Forward) | 20. Railings (Platform D7) | 34. Funnel Sirens |
| 7. Railings (Platform E6) | 21. Railings (Signal Platform) | 35. Aircraft Crane Hooks |
| 8. Railings (Platform E6) | 22. Railings (Aft Director Tower) | 36. Optical Sight Covers |
| 9. Railings (Forward Searchlight Platform) | 23. Railings (Aft Director Tower) | 37. Aircraft Crane Rigging |
| 10. Railings (Secondary Gun Deck Aft) | 24. Railings (Aft Director Tower) | 38. Boat Crane Hooks |
| 11. Railings (Platform D30) | 25. Railings (Main Deck Step) | 39. Leadsman's Platforms |
| 12. Railings (Bow Sections) | 26. Railings (Platform D16) | 40. Breda 3.7cm Twin Gun Fittings |
| 13. Railings (Lower Superstructure) | 27. Bridge Front Loop Antenna | 41. 4m Dinghy Cradles |
| 14. Railings (Lower Superstructure) | 28. "Gufo" Radar Antenna | 42. 10m Motor Boat Cradles |

© WHITE ENSIGN MODELS LTD 2014

Unit 5, Cobnash Industrial Estate, Kingsland, Leominster, HR6 9RW, U.K. Tel. 01568 709149 or Fax 01568 709182
E-mail: info@whiteensignmodels.com Website: <http://WhiteEnsignModels.com>

PARTS LIST (Part B)

© WHITE ENSIGN MODELS 2014

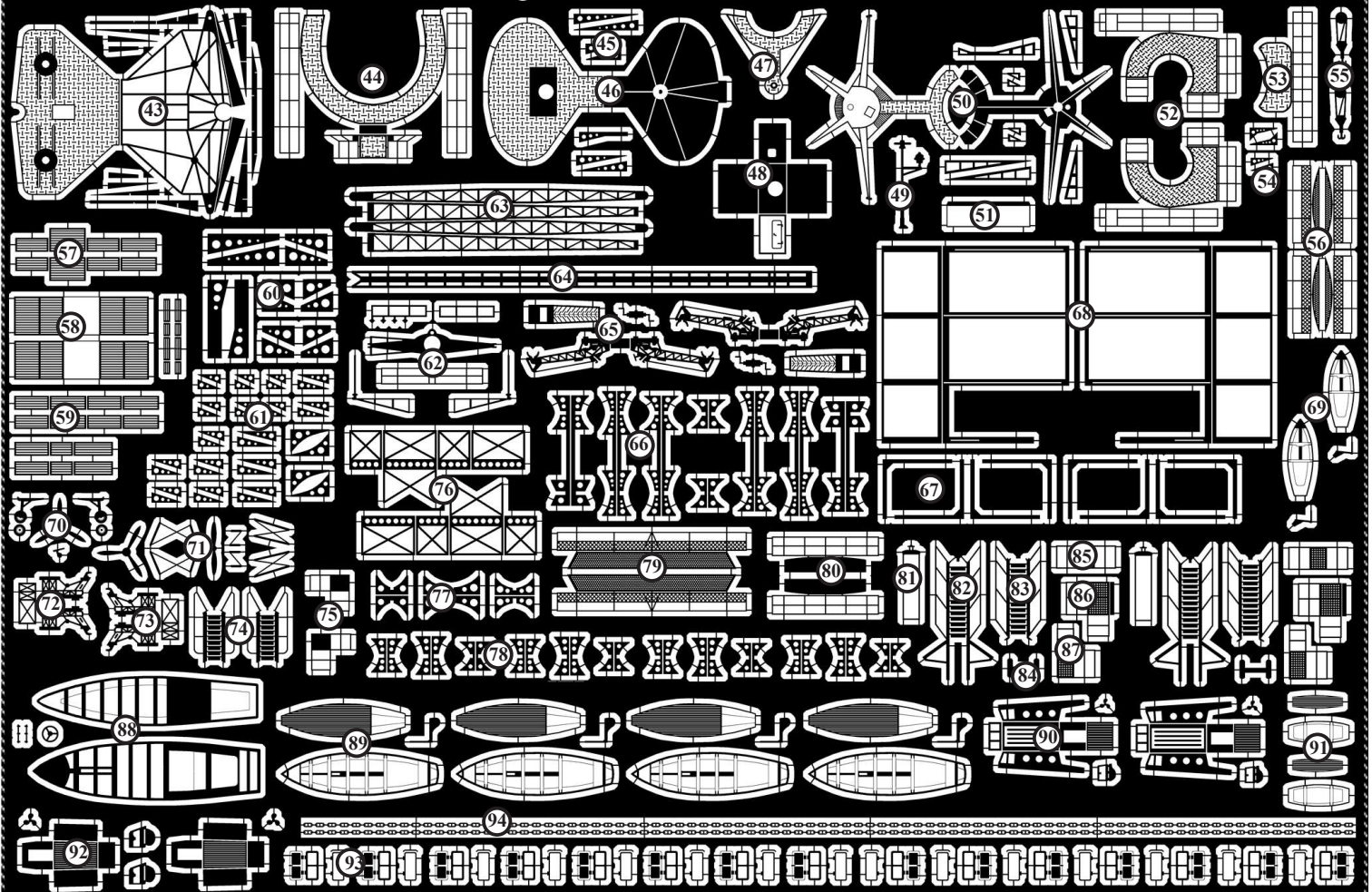

RN ROMA 1/350 SCALE PART B

43. Forward Searchlight Platform	56. Gun Deck Extensions	69. 4m Dinghy Fittings	82. Accommodation Ladder (Lower)
44. Funnel Catwalk	57. Box Vent Louvres	70. Re2000 Aircraft Parts	83. Accommodation Ladder (Upper)
45. Signal Platform Supports	58. Box Vent Louvres	71. Ro43 Aircraft Parts	84. Docking Fender
46. Signal Platform	59. Box Vent Louvres	72. Aircraft Launch Cradle Ro43	85. Ladder Landing (Mid Platform)
47. Platform D7 Forward	60. AA Director Platform Supports	73. Aircraft Launch Cradle Re2000	86. Ladder Landing (Top Platform)
48. Wireless House for Signal Platform	61. Tower Lower Platform Supports	74. Inclined Ladders (Mid Superst.)	87. Ladder Landing (Lower Platform)
49. Foretop Radar Mast Antenna Array	62. Mainmast Starfish Platform	75. Ladder Landings	88. 13m Motor Launch Fittings
50. Foretop Starfish Assembly	63. Aircraft Crane Jib	76. Aircraft Stowage Frames	89. 8.6m Lifeboat Fittings
51. Foretop Platform Bulwark	64. Catapult Top Track	77. 13m Motor Launch Cradles	90. 10m Motor Boat Fittings
52. Secondary Director Platforms	65. Paravane Rig	78. 8.6m Lifeboat Cradles	91. 3.5m Punt Fittings
53. Funnel Siren Platform	66. Aft Upper Boat Frame Cradles	79. Amidships Gun Deck Extensions	92. 12.5m Motor Boat Fittings
54. Siren Platform Supports	67. Upper Boat Frame Braces	80. Foretop Director Entry Platforms	93. Superstructure Doors
55. Aircraft Crane Hooks	68. Upper Boat Frame	81. Accommodation Ladder Yoke	94. Anchore Chain

Instructions for working with Photoetched Metal

- Do not remove the etched parts from the fret until you are ready to use them.
- Before assembly, soak the etched parts in a suitable solvent, such as white spirit, to de-grease the surfaces for painting.
- Cyanoacrylate adhesive (super glue) or contact adhesive such as Elmers white glue may be used. These can be applied with a pin or piece of stretched sprue.
- When removing parts from the fret, place the fret on a hard surface, such as a smooth ceramic tile, in order to prevent parts bending whilst cutting through the holding tabs. We suggest using a #11 type of modelling knife blade for this purpose.
- When shaping or bending a part, a straight-edged blade such as a chisel blade #17 or # 18 will give a good sharp corner, or alternatively a small pair of smooth-jawed pliers may be used.
- If a part is bent incorrectly, lay it on a hard flat surface and roll it flat with a cylindrical object such as a modelling knife handle.
- We suggest that where stock lengths of rails are supplied, these are pre-measured before cutting, where practical, using a pair of compass dividers & then tacked to the deck edge every third or fourth stanchion with a small drop of glue. When a section is complete, run a thin line of glue along the inside edge to attach it firmly to the deck.

INTRODUCTION

- This detail set has been designed to help the modeller enhance the appearance of the Trumpeter kit of *RN Roma* in 1/350 scale by adding details that are too fine to be reproduced as plastic moldings, or by replacing parts that are, by the nature of them, too out of scale or lacking in detail. This is by no means a definitive set of super details, but is aimed at correcting the kit manufacturer's errors as well as supplying a few basic cosmetic parts to enhance an otherwise excellent kit.
- We suggest that these instructions be studied thoroughly before an attempt is made at using the parts provided. References are made to locations of parts in the parts lists as well as in the particular sections relating to assembly.
- We recommended that further research is done when modeling this kit, & an excellent reference can be found in the Seaforth publication *The Littorio Class* by Erminio Bagnasco & Augusto de Toro. This shows clear references & plans as to how the ships appeared at various time frames in their short careers. Also the Profile Morskje No 120 set of plans for *RN Roma* 1943 are a good source of information for the more detailed areas, & are in general agreement with those plans to be found in the *Littorio Class* publication.
- While every effort has been made to ensure as full an explanation as possible of the parts included in this set and their assembly to the relevant kit, sometimes one or two items may appear to get overlooked. If there are no assembly diagrams in the main part of the instructions then there should be a text explanation in the other instructions section or a location of parts provided in the parts list. If there is still difficulty in establishing how a part is assembled or located on the kit, contact White Ensign Models & we will be pleased to help resolve the problem.

BREDA 3.7 CM TWIN AA GUN MOUNT

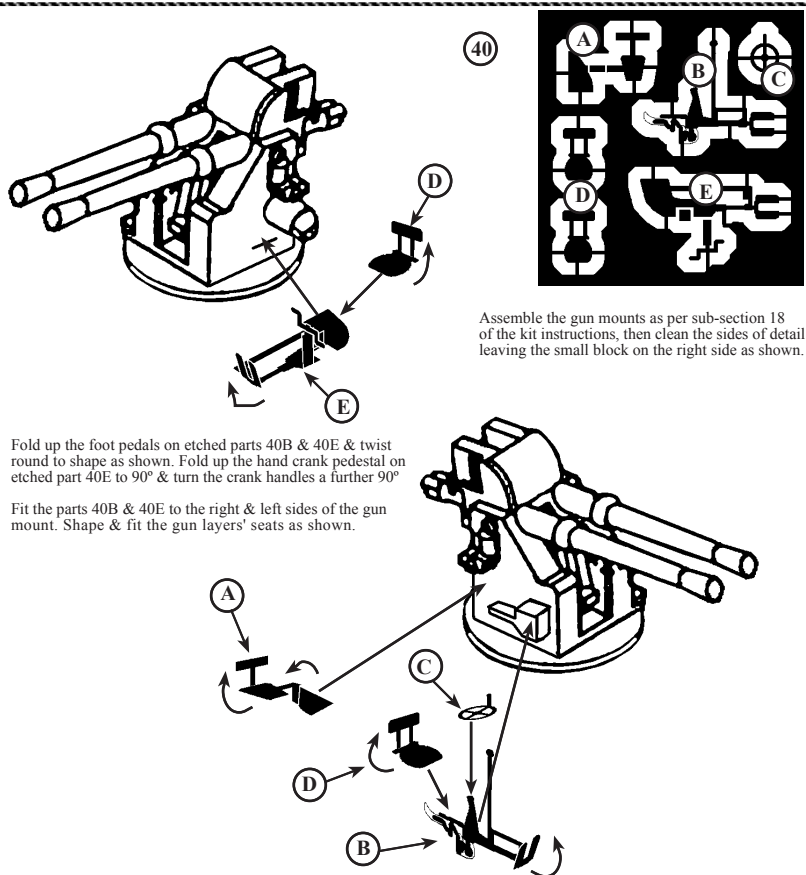

Assemble the gun mounts as per sub-section 18 of the kit instructions, then clean the sides of detail leaving the small block on the right side as shown.

Fold up the foot pedals on etched parts 40B & 40E & twist round to shape as shown. Fold up the hand crank pedestal on etched part 40E to 90° & turn the crank handles a further 90°

Fit the parts 40B & 40E to the right & left sides of the gun mount. Shape & fit the gun layers' seats as shown.

BREDA 20 MM TWIN AA GUN MOUNT

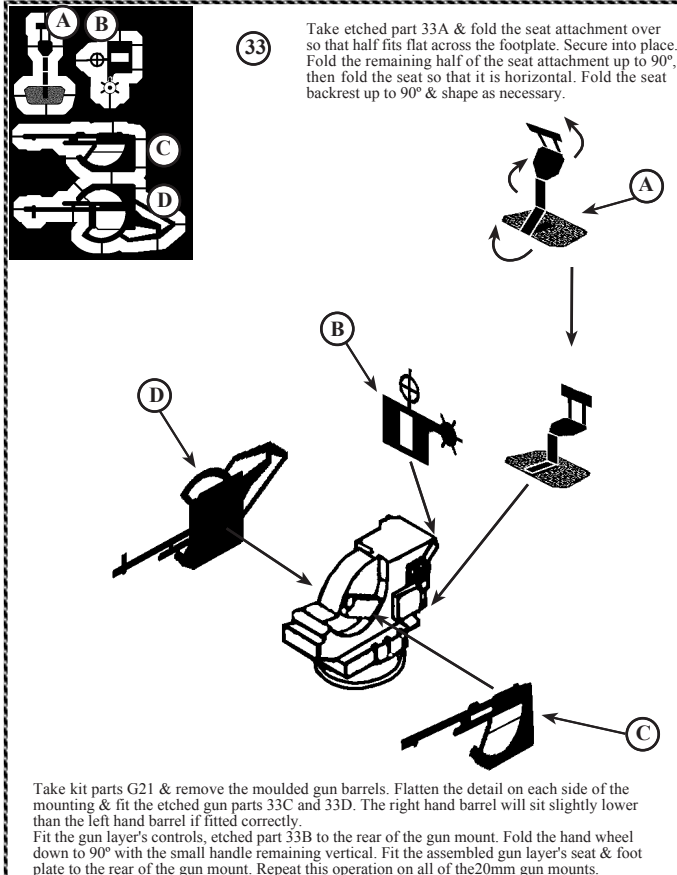

Take etched part 33A & fold the seat attachment over so that half fits flat across the footplate. Secure into place. Fold the remaining half of the seat attachment up to 90°, then fold the seat so that it is horizontal. Fold the seat backrest up to 90° & shape as necessary.

Take kit parts G21 & remove the moulded gun barrels. Flatten the detail on each side of the mounting & fit the etched gun parts 33C and 33D. The right hand barrel will sit slightly lower than the left hand barrel if fitted correctly. Fit the gun layer's controls, etched part 33B to the rear of the gun mount. Fold the hand wheel down to 90° with the small handle remaining vertical. Fit the assembled gun layer's seat & foot plate to the rear of the gun mount. Repeat this operation on all of the 20mm gun mounts.

FOREMAST STARFISH PLATFORM ASSEMBLY

Fit the lower plate of etched part 50 to the upper plate, so that the platform is double thickness with the etched detail outermost.

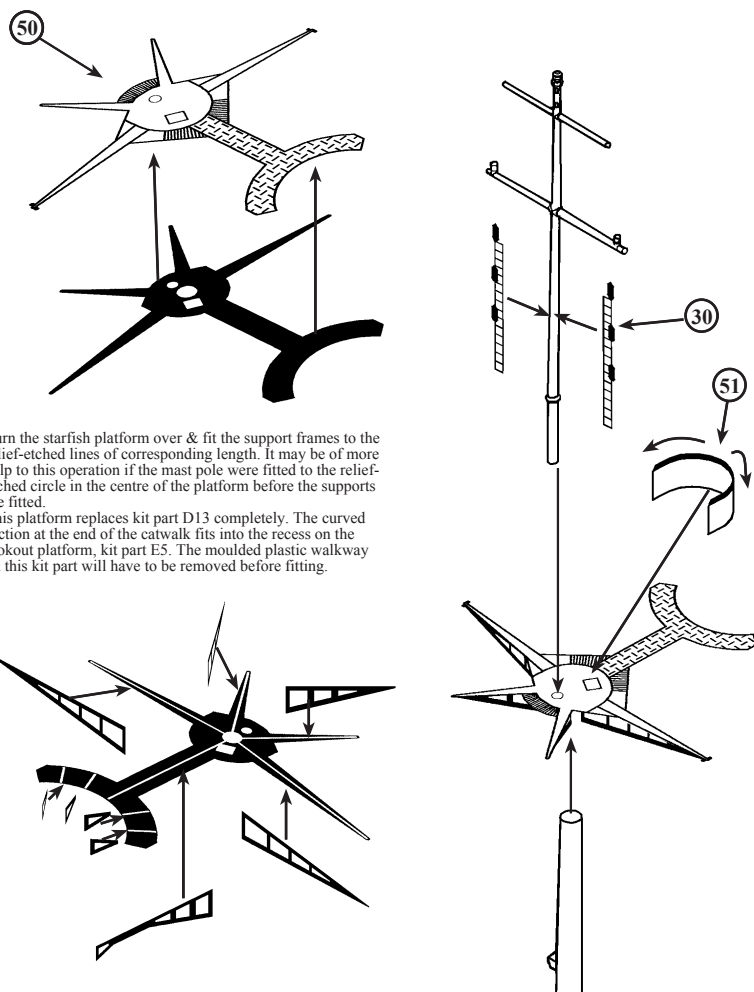

Turn the starfish platform over & fit the support frames to the relief-etched lines of corresponding length. It may be of more help to this operation if the mast pole were fitted to the relief-etched circle in the centre of the platform before the supports are fitted.

This platform replaces kit part D13 completely. The curved section at the end of the catwalk fits into the recess on the lookout platform, kit part E5. The moulded plastic walkway on this kit part will have to be removed before fitting.

Fit part A8, the kits fore top mast, to the replacement platform as per kit instructions. Fit the position light arrays, etched parts 30 to each side of the top mast, so that the bottom of the ladders fit onto the platform. Gently curve the bulwark, etched part 51, to fit around the outside of the curved portion of the platform.

EC-3 'GUFO' RADAR ANTENNA

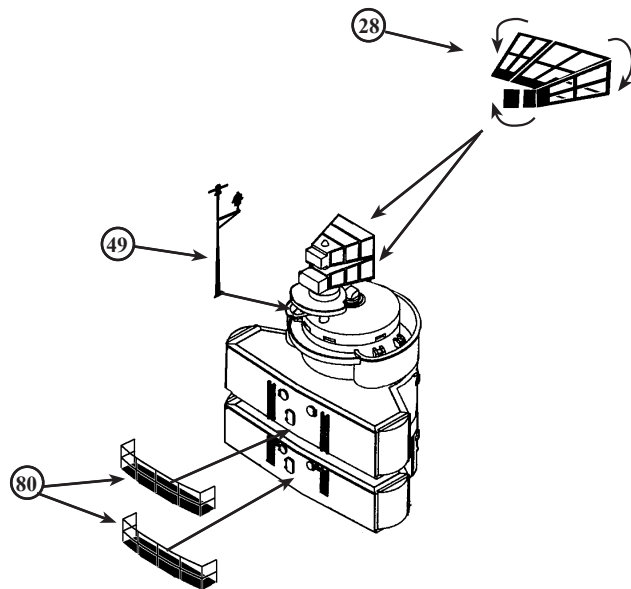

Although there are etched parts in the kit for the radar antennas, we felt that they could be made more accurate. Etched parts 28 are assembled as shown here to replace the double antenna on top of the foretop on *Roma*. Assemble to the kit parts as shown in the kit instructions. Replace the vertical pole on kit part C1 with etched part 49. Remove the moulded plastic platforms from the rear walls of the main directors, kit parts B21 & B29. Fold railings on etched parts 80, up to 90°, & shape to fit around the edges of the platforms. Fit the replacement platforms to the rear walls of the directors as shown.

PARAVANE HANDLING GANTRY

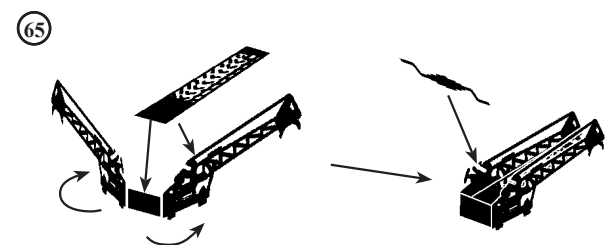

Fold the side panels of etched parts 65 around to 90° so that they are parallel. Fit the horizontal plate in between the side panels along the lower longitudinal rail & secure into place. Fit the crank handle into the slots on top of the side panels. Make two & use to replace kit parts J46 & the kit's PE option.

FORWARD SEARCHLIGHT PLATFORM ASSEMBLY

This platform has been provided to replace the rear section of kit part E16, the forward search light platform, which is incorrectly shaped. Remove the plastic platform from the kit part by cutting a straight line across the waisted area between the two narrowest points. Fold the etched platform 43 in half so that the relief-etched detail is outermost & secure in place.

Turn the platform upside down & fold up the two rear supports to 90°. Fit the longitudinal brace, etched parts 43A to the etched lines so that the higher rear end fits against the rear supports. Fit the two large supports, etched parts 43F, so that they slot together with parts 43A. Fit supports 43C & 43D as shown below.

Next fit the forward support brace, etched part 43G across the platform so the inner slots interlock with those on parts 43A. Fit supports, etched parts 43B so the slots interlock with those outer slots on parts 43G. Fit the remaining braces, etched parts 43E as shown.

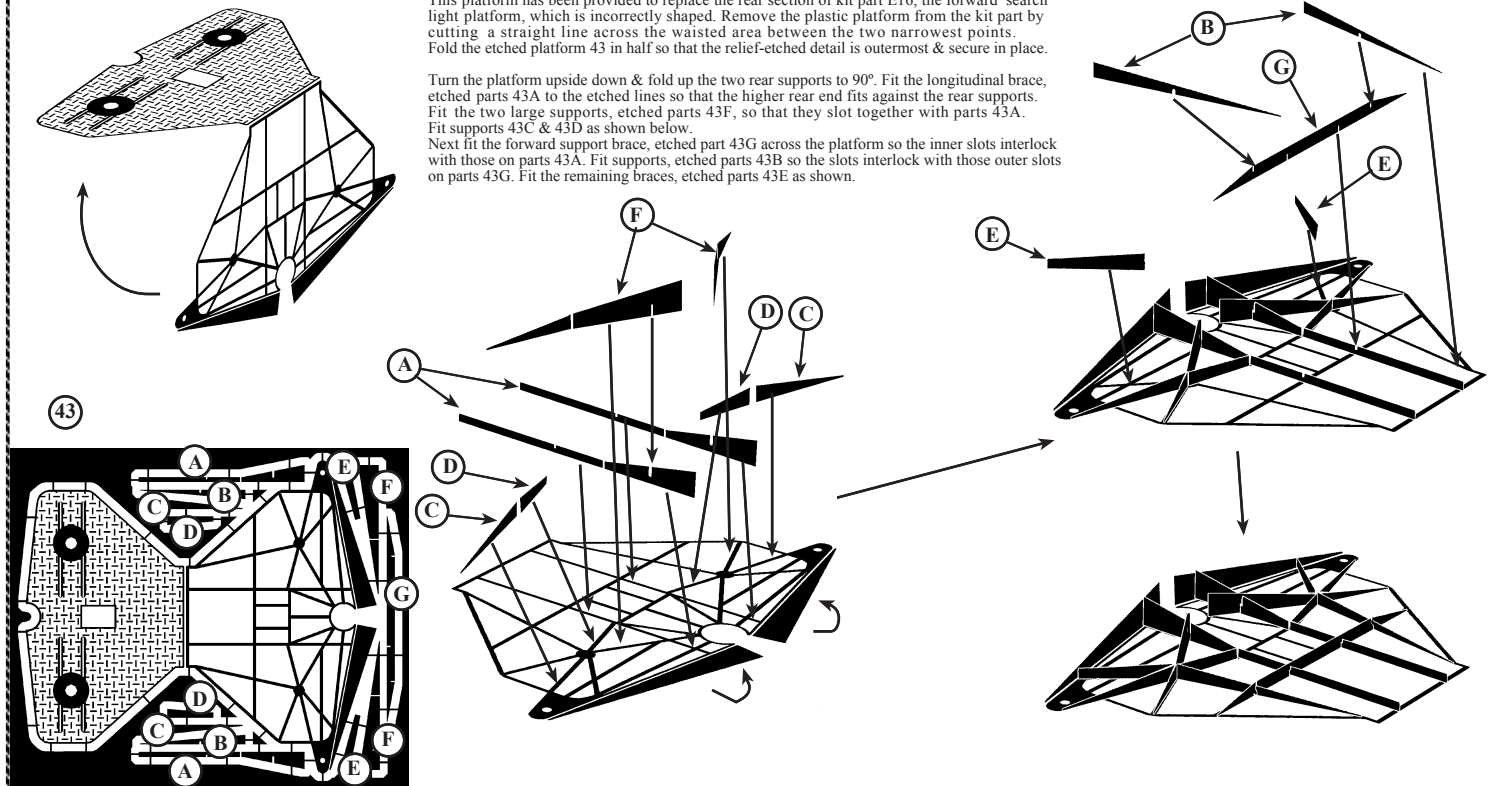

SIGNAL PLATFORM ASSEMBLY

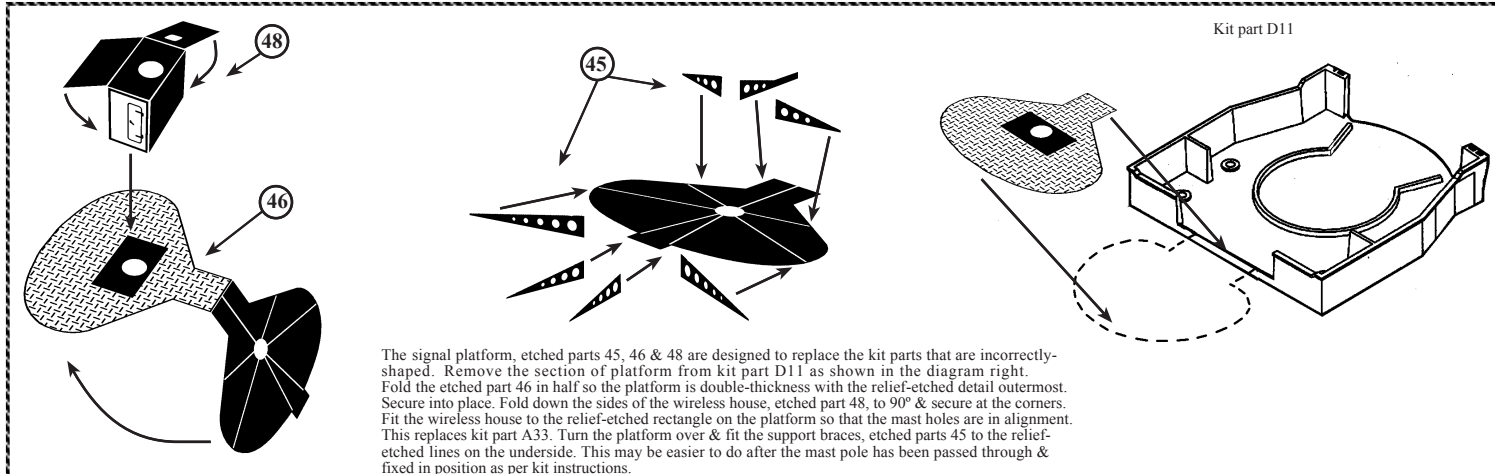

The signal platform, etched parts 45, 46 & 48 are designed to replace the kit parts that are incorrectly-shaped. Remove the section of platform from kit part D11 as shown in the diagram right. Fold the etched part 46 in half so the platform is double-thickness with the relief-etched detail outermost. Secure into place. Fold down the sides of the wireless house, etched part 48, to 90° & secure at the corners. Fit the wireless house to the relief-etched rectangle on the platform so that the mast holes are in alignment. This replaces kit part A33. Turn the platform over & fit the support braces, etched parts 45 to the relief-etched lines on the underside. This may be easier to do after the mast pole has been passed through & fixed in position as per kit instructions.

LOWER TOWER PLATFORM SUPPORTS LOCATION

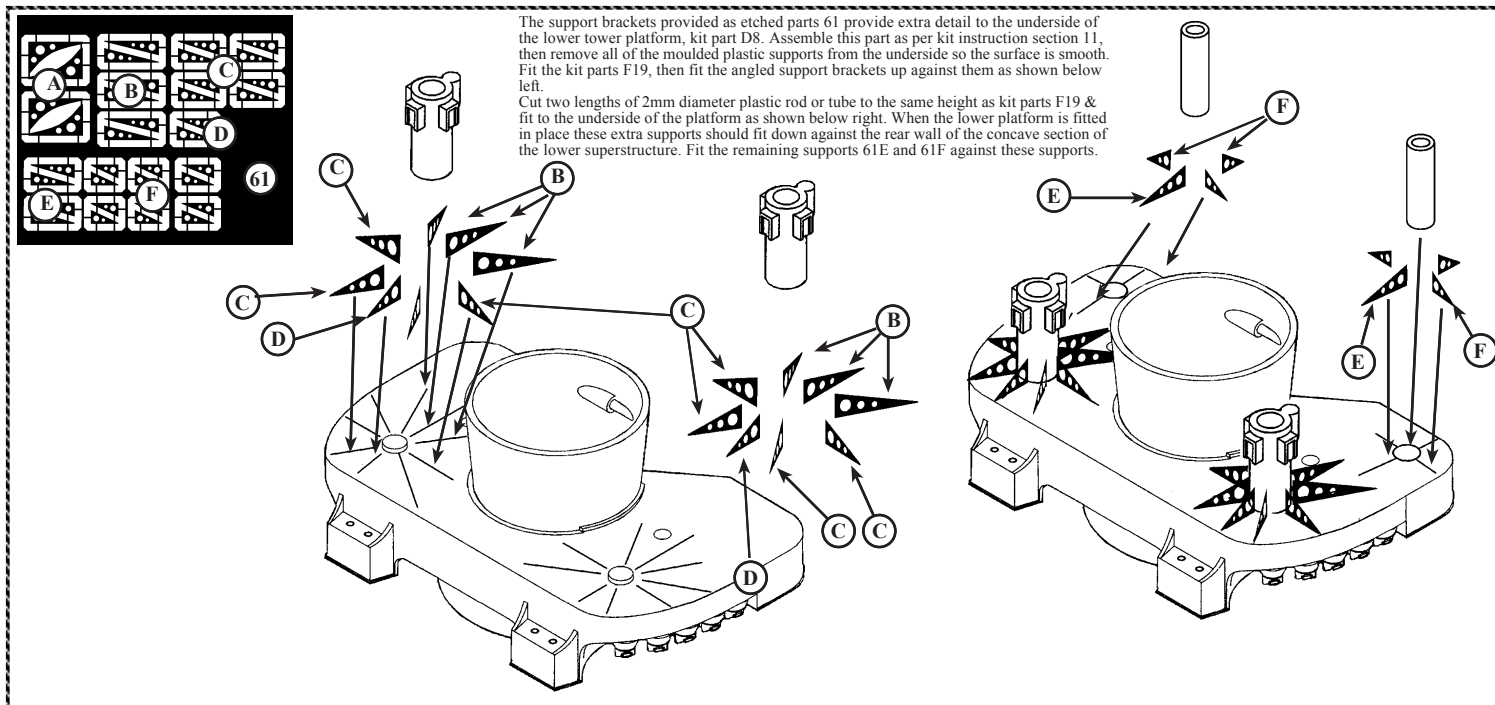

FORWARD SUPERSTRUCTURE TOWER PARTS LOCATION

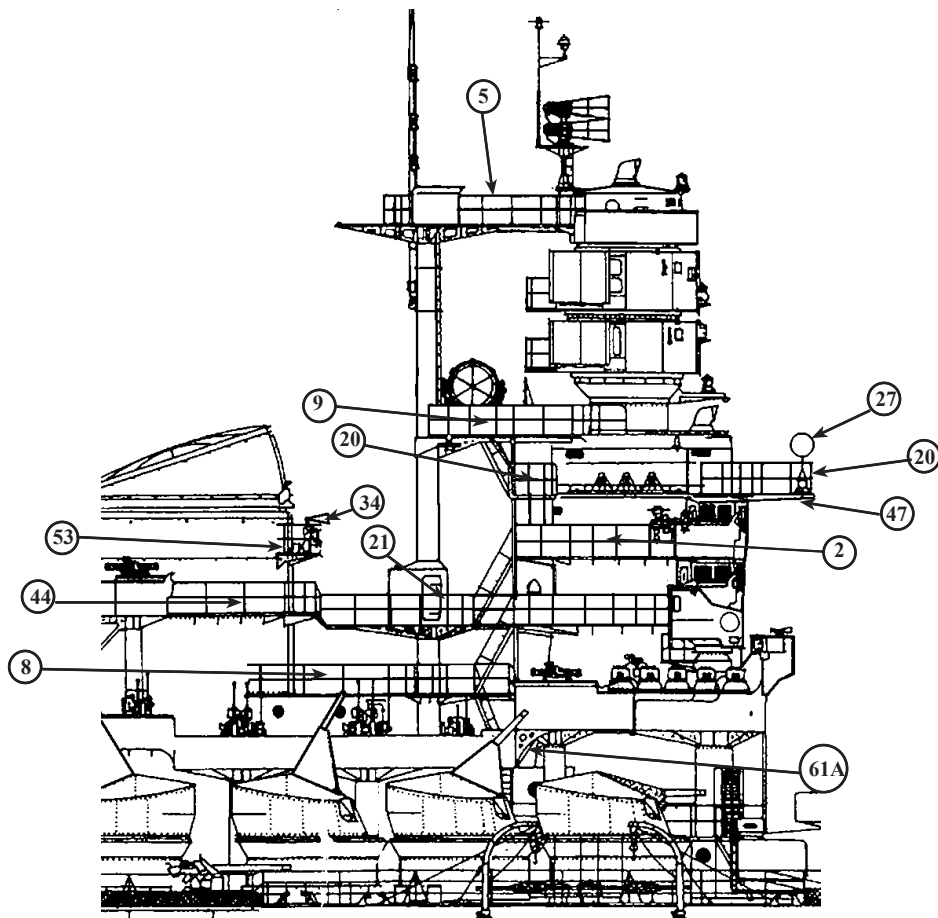

The diagram left has been included to show the location of some of the smaller etched parts in relation to the assembled kit parts. Starting from the top, after the foremast starfish platform has been fitted into place, the longer sections of the railings, etched parts 5 can then be shaped & fitted to the sides of the starfish platform. The short section fits to the rear edge of the platform. The two sections of railing, etched part 9, fit around the edge of the searchlight platform, starting at the mast & ending with the curved top part fitting on the conning tower roof. Etched parts 20 are the railings for the conning tower deck. The forward longer section fits around the front of the DF antenna platform. The rear section fits along the rear edges of kit part D7.

Platform kit part D7 also needs to have the front part where the DF antenna platform is located, removed & replaced with etched part 47 if desired.

The remainder of the railing sections are fitted to the platforms as shown.

Support brackets for the lower platform, etched parts 61A are fitted so that the vertical edge is directly against the forward face of the director platform on each side of the superstructure, kit parts D4 & D5. Two brackets are fitted on each side, being toed outwards as they pass under the lower platform.

DIRECTOR PLATFORM SUPPORTS

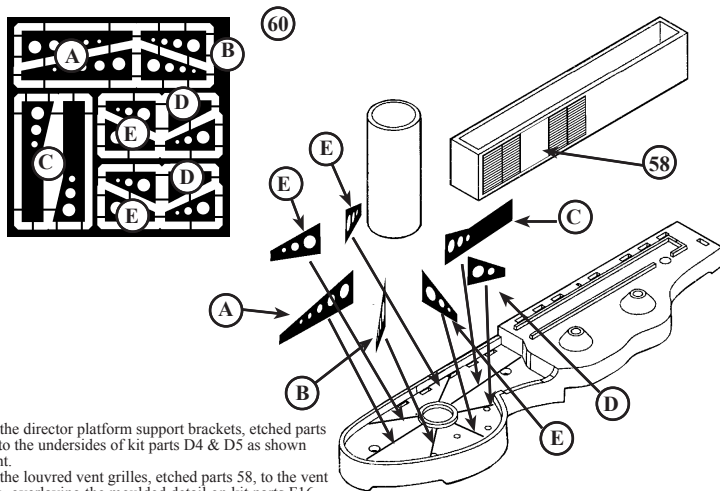

Fit the director platform support brackets, etched parts 60 to the undersides of kit parts D4 & D5 as shown right.
Fit the louvred vent grilles, etched parts 58, to the vent box, overlaying the moulded detail on kit parts F16.

SECONDARY DIRECTOR ACCESS PLATFORMS

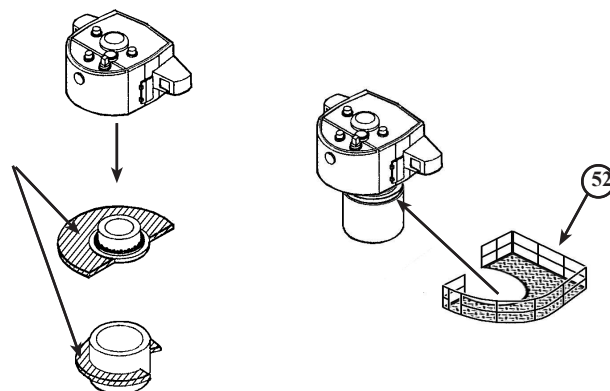

Remove the moulded plastic access platforms from the aft director support towers, kit parts J7 & J30 as shown by the hatched area on the above left diagram.
Replace the upper platform with etched parts 52 as shown, bearing in mind that they are mirrored for port or starboard fitting.

ROMA FUNNEL PLATFORM CORRECTION

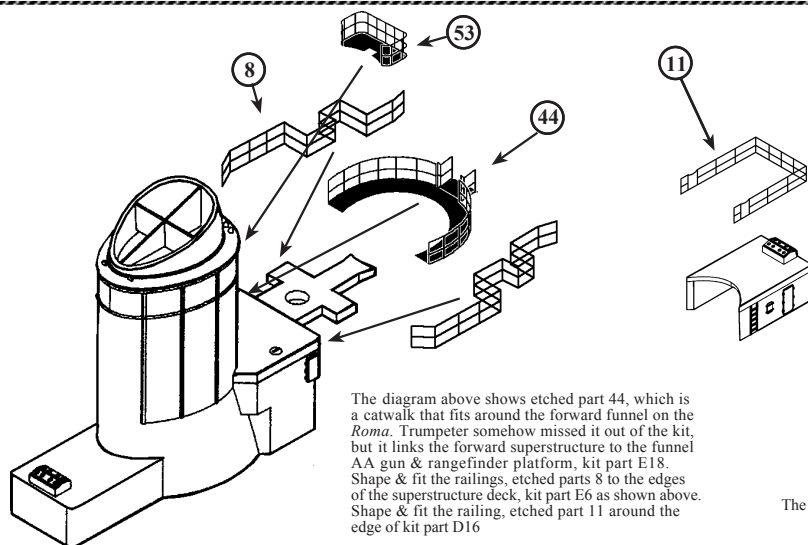

The diagram above shows etched part 44, which is a catwalk that fits around the forward funnel on the *Roma*. Trumpeter somehow missed it out of the kit, but it links the forward superstructure to the funnel AA gun & rangefinder platform, kit part E18. Shape & fit the railings, etched parts 8 to the edges of the superstructure deck, kit part E6 as shown above. Shape & fit the railing, etched part 11 around the edge of kit part D16

The siren platform, etched part 53, is included to replace kit part C7. The support brackets etched parts 54 fit to the underside of the platform when it is fixed in position. The sirens, etched parts 34, are folded in half to make them double-thickness before they are fitted to the siren platform.

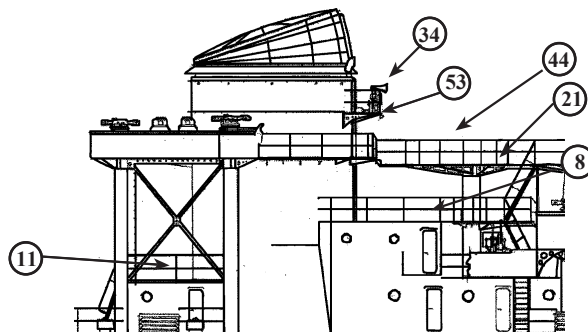

The profile diagram above shows the location of the etched parts in relation to the kit assemblies.

MAINMAST PLATFORM

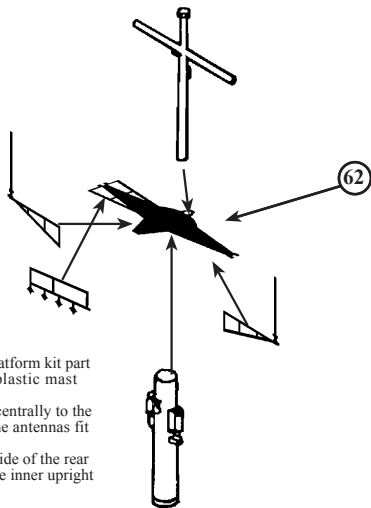

Replace the moulded plastic mainmast platform kit part A12, with etched parts 62, using the plastic mast parts from the kit as shown right.
Fit the yardarm supports with antennas, centrally to the underside of the platform arms so that the antennas fit into the slots on the ends of the arms.
Fit the signal halyard frame to the underside of the rear frame on the port side yardarm, so that the inner upright fits against the mast pole.

QUARTERDECK RAILING LAYOUT

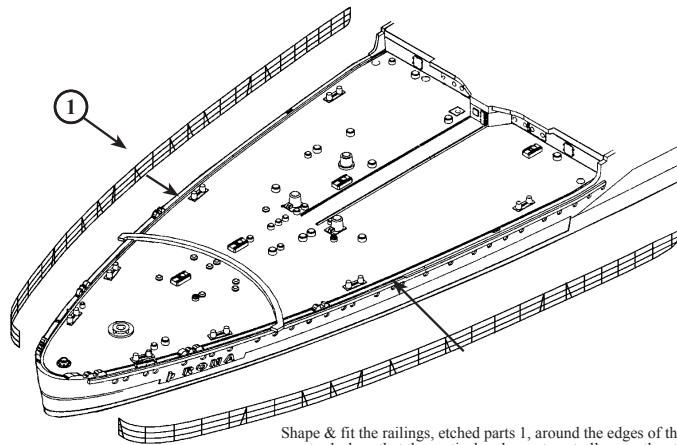

Shape & fit the railings, etched parts 1, around the edges of the quarterdeck so that the vertical ends meet centrally over the stern. The shaped end should fit into the spray shields on each side of the hull step.

HULL STEP RAILINGS & MIDSHIPS GUN DECK EXTENSIONS

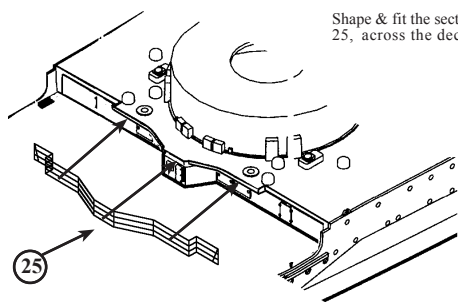

Shape & fit the sections of railing, etched part 25, across the deck edge at the hull step.

Fold the last section of railing on etched parts 4 round to 90°, then fit railing to the deck edge just forward of the hull step on both sides. The short sections of railing should continue on from the main deck railing, with a gap between part 4 & part 25 being the ladder access down to the quarterdeck.

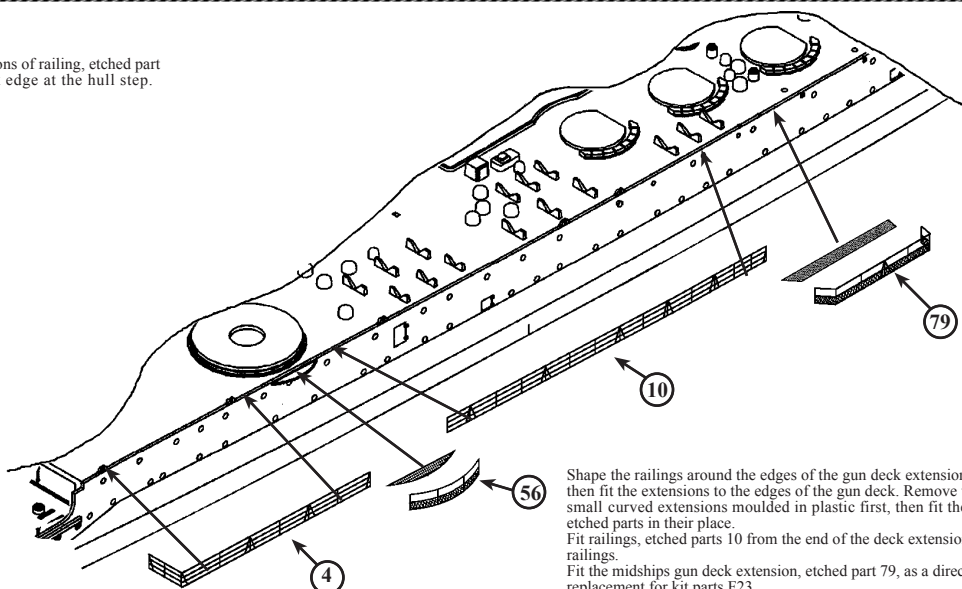

Shape the railings around the edges of the gun deck extensions, then fit the extensions to the edges of the gun deck. Remove the small curved extensions moulded in plastic first, then fit the etched parts in their place.
Fit railings, etched parts 10 from the end of the deck extension railings.
Fit the midships gun deck extension, etched part 79, as a direct replacement for kit parts F23.

FORE DECK RAILINGS & GUN DECK EXTENSIONS

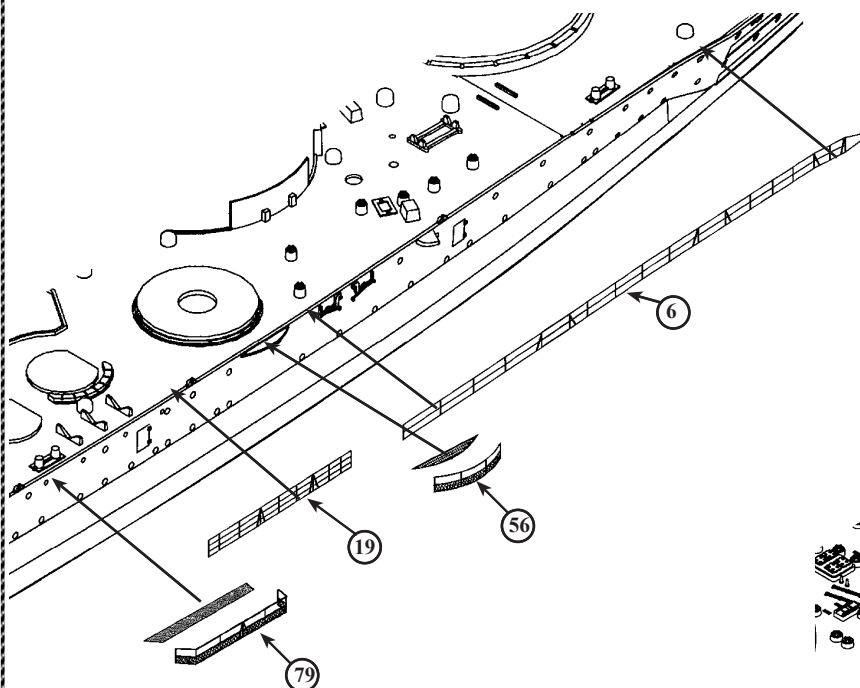

Fit etched railing section 3 to continue forward from railing section 6. Bend the short angled section inwards at the anchor stowage.
Fit the bow section of railing, etched part 12, so that the forward 2-rail section fits to the jack staff. Curve the forward-most area of the railing to fit against the deck edge. The rear short angled section is bent inwards to fit against the forward edge of the anchor stowage.

Shape & fit the railing section around etched part 79 & fit on both sides of the hull in the place of kit parts F23.
Fit the railing section, etched part 19 from the end of the railings on the deck extension 79 so that it fits between the extensions 79 & the forward extension 56.
Fit the long railing section, etched part 6, to the edge of the main deck from extension 56 forward past the angled section of hull.

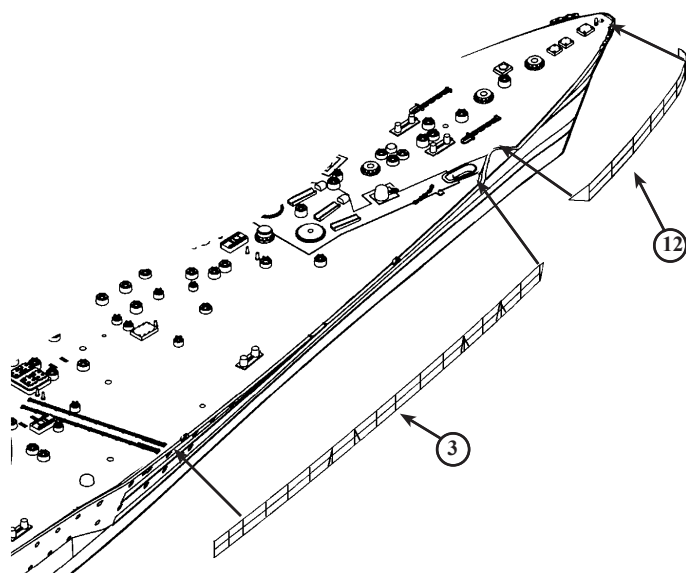

LOWER SUPERSTRUCTURE RAILING LOCATION

Shape the railing sections, etched parts 13, so that they are mirror images, then fit to the forward edges of the lower superstructure deck. Fit the remaining sections of railing to the edges of the superstructure deck as shown below.

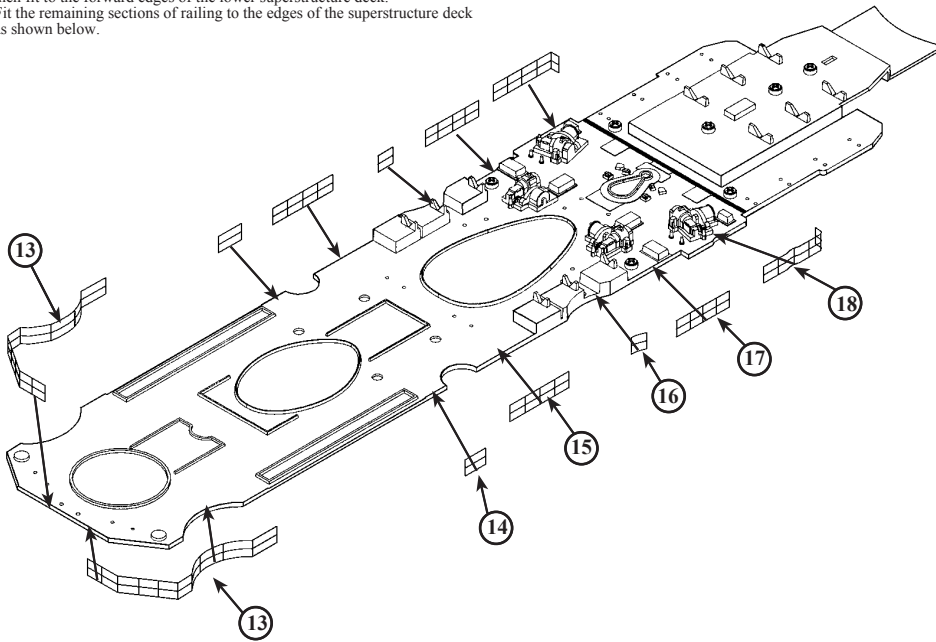

OPEN BOAT FITTINGS

Replace kit part J39, with the etched part 69, 4m Dinghy Thwarts. Fit rudder to the stern post as shown.

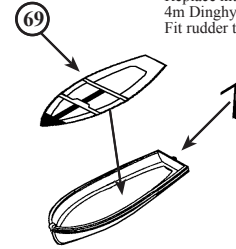

Using kit parts J3 as the hulls, fit the boats' floor sections of etched parts 89 into the bottom of the hulls & secure into place. The fit the thwarts as replacements for kit parts J1. Make four of these for the *Roma*.

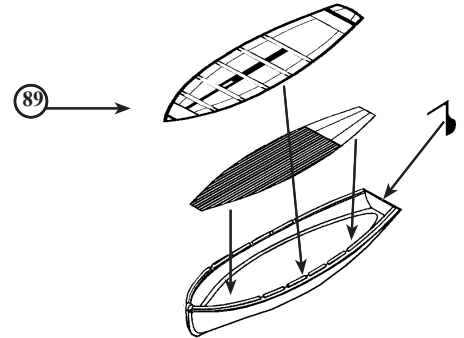

MOTOR BOAT DETAILS & CORRECTIONS

13-metre Motor Launch

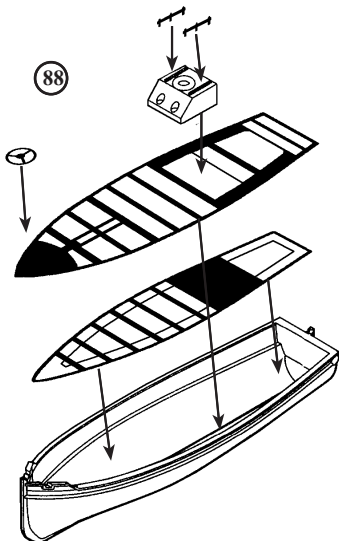

Remove the moulded plastic cabin from kit part G18 & fit onto etched part 88 as shown above. Fit the boat floor into the bottom of the hull, kit parts G1 & G5. Fit the thwarts into the top of the hull, replacing kit part G18. Finish off the boat by fitting the handrails to the top of the cabin & the circular item to the bow.

10-metre Motor Boat x 2

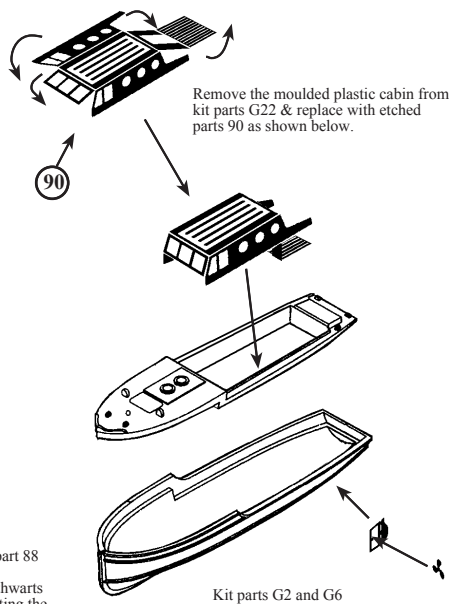

Kit parts G2 and G6

12.5-metre Motor Boat x 2

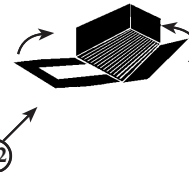

Shape & fit the cockpit well to the rear of the large motor boat as shown below. Cut away the rear of the skeg on the underside of the hull & fit the propeller and rudder unit.

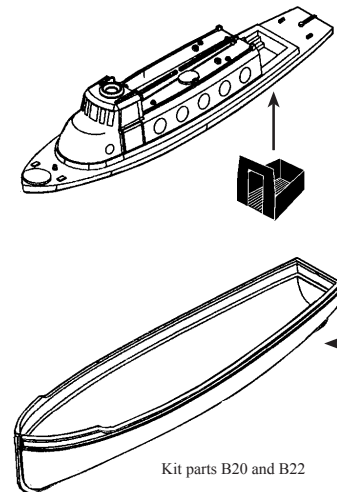

Kit parts B20 and B22

BOAT CRADLE FRAME CORRECTION

The following etched parts have been included in the set, though doubt remains as to whether or not the boat fit supplied in the kit was actually fitted to *Roma*. The photographic evidence suggests that a lot of the boats were never fitted & that a cropped fit of two pairs of motor boats occupied the superstructure deck cradles. If it is desired to build the model with the full fit then these frames & cradles are more accurate than the moulded-on the kit parts as this is how the other two ships of the class were fitted.

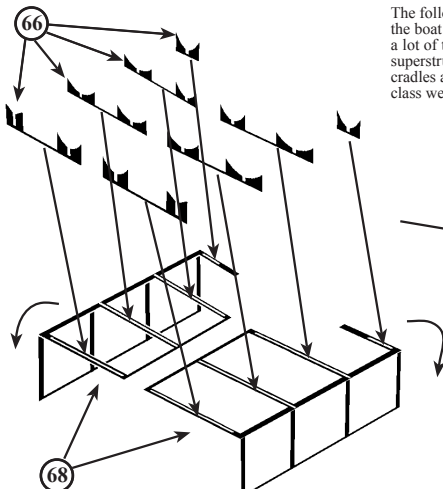

Fold down the side supports of the boat cradle frames to 90° so that the frames are mirror images. Fold the boat cradles, etched parts 66, in half so that they are double-thickness. Fit the boat cradles into the rear slots on the frames, moving forward in sequence as the cradles are fitted in the fret, until the single cradle is fitted to the forward frame

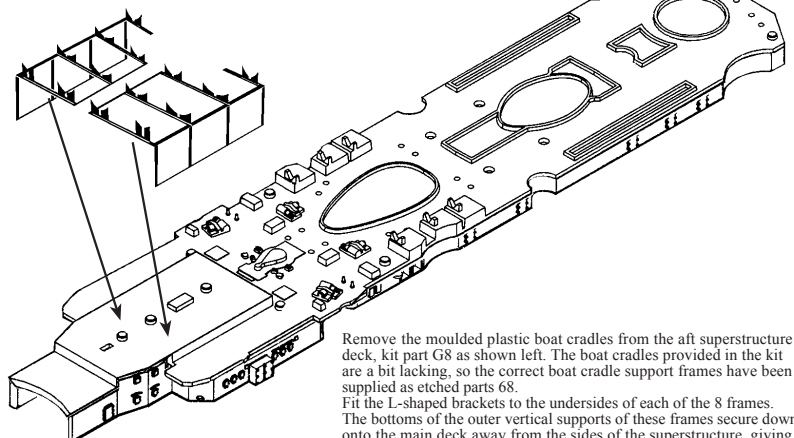

Remove the moulded plastic boat cradles from the aft superstructure deck, kit part G8 as shown left. The boat cradles provided in the kit are a bit lacking, so the correct boat cradle support frames have been supplied as etched parts 68. Fit the L-shaped brackets to the undersides of each of the 8 frames. The bottoms of the outer vertical supports of these frames secure down onto the main deck away from the sides of the superstructure, giving the boat cradles a certain amount of overhang.

AIRCRAFT RECOVERY CRANE

Etched part 63 has been supplied as a more accurate representation of the crane supplied in the kit as Part PE 23. This is assembled & fitted to the crane post in the same way as shown in the kit instructions.

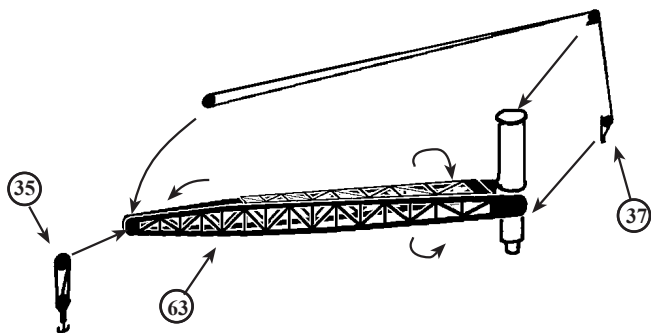

Additional parts provided in this set are etched part 37, which is the crane's rigging lines & pulley wheels. The short run is fitted to the rear of the crane post as shown above, with the outer pulley wheel fitting between the outer ends of the crane jib. Fit the crane hook, etched part 35 in between the outer ends of the crane jib also.

AIRCRAFT LAUNCH CRADLES & STOWAGE FRAMES

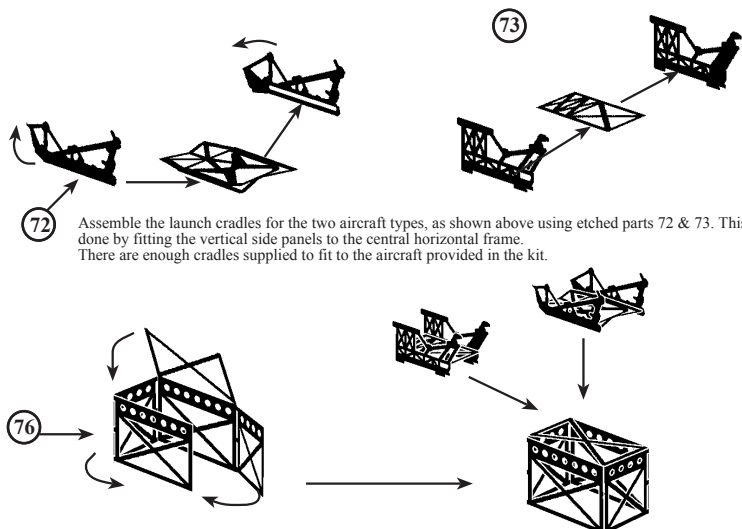

Assemble the launch cradles for the two aircraft types, as shown above using etched parts 72 & 73. This is done by fitting the vertical side panels to the central horizontal frame. There are enough cradles supplied to fit to the aircraft provided in the kit.

Fold the side panels of the aircraft stowage frames around in stages of 90° until the outer ends meet. Secure into place. Fold down the top cross-bracing so that it lays horizontally across the top of the frame. Four of these have been supplied to fit four of the aircraft onto. The fifth aircraft will be fitted onto the catapult.

DETAILS FOR THE Re2000 & Ro43 AIRCRAFT

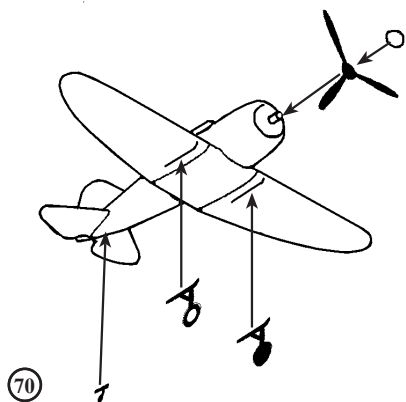

The Re2000 aircraft that comes in the kit has an under carriage provided, but etched parts 70 provide an alternative that may be fitted instead if desired. A replacement propeller is also supplied & is fitted directly onto the hub boss on the front of the aircraft. The propeller spinner may be cut from the kit part & fitted onto the front of the propeller as shown left.

The Ro43 floatplane may be detailed further by fitting the interplane struts provided in etched parts 71. The solid plastic central float attachment may also be cut away from the kit part & replaced with the etched struts as shown right. The same applies to the wingtip struts, though these may well be a little more tricky to fit, & is up to the modeller if they are fitted. There are 2 different propellers that may be used as replacements. One is a 2-bladed propeller that was fitted to the earlier aircraft.

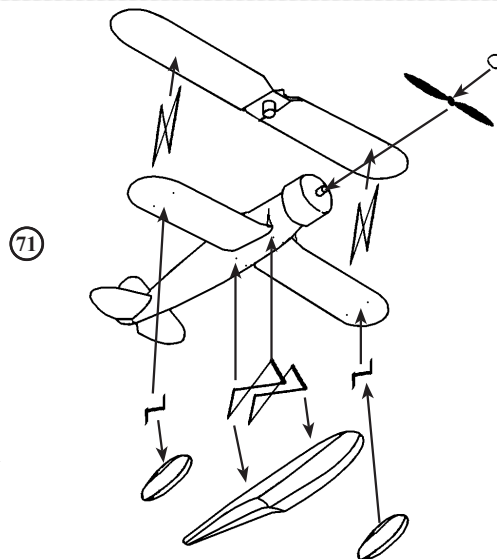

LADDER ASSEMBLY

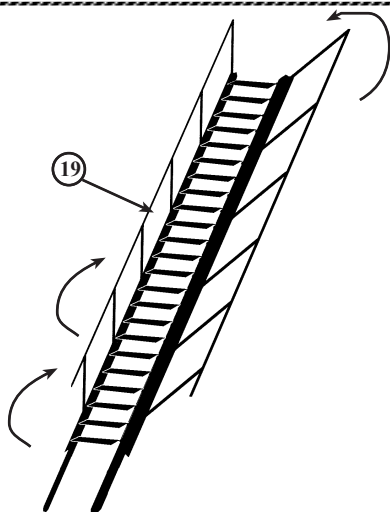

Fold up the handrail/side to 90° with a chisel blade lifting the handrail evenly all the way along. When this is complete, flip the ladder over so that the opposite handrail is flat on the tile or plate & hold down again with a steel rule so that the steps are protruding. Fold up to 90° so that the handrails are now parallel.

Using a pair of needle point tweezers & starting at the top, turn each step so that it is placed between the sides at the desired angle.

The diagram above shows the lower section of accommodation ladder, which is assembled in the same way. A broader chisel blade for lifting the fold will help get an even line along the folded edge.

ACCOMMODATION LADDER PLATFORM ATTACHMENT

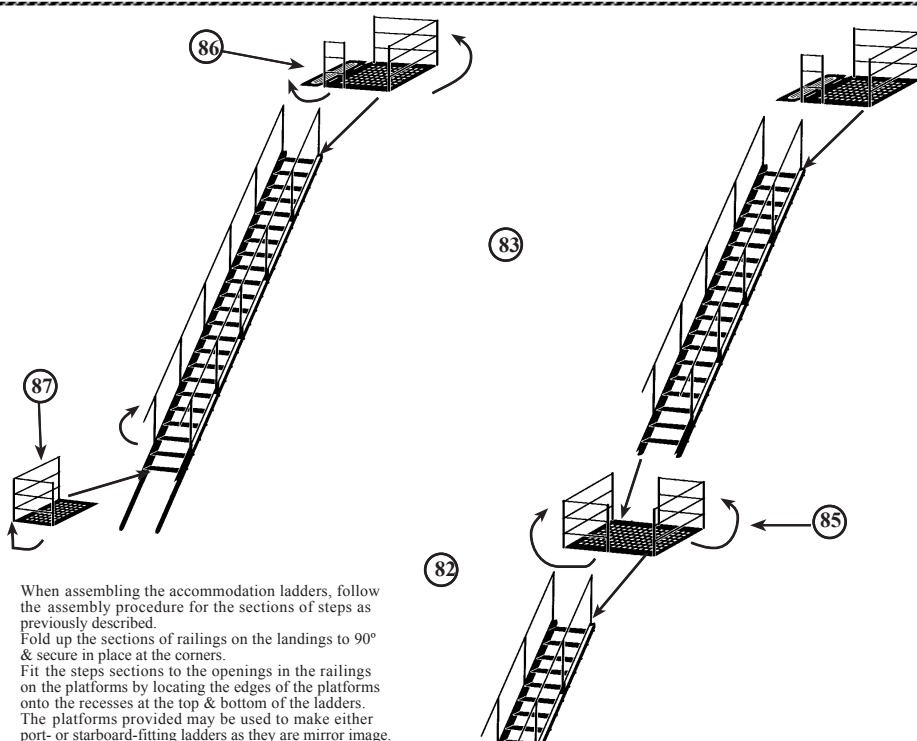

When assembling the accommodation ladders, follow the assembly procedure for the sections of steps as previously described. Fold up the sections of railings on the landings to 90° & secure in place at the corners. Fit the steps sections to the openings in the railings on the platforms by locating the edges of the platforms onto the recesses at the top & bottom of the ladders. The platforms provided may be used to make either port- or starboard-fitting ladders as they are mirror image.

LADDER RIGGING

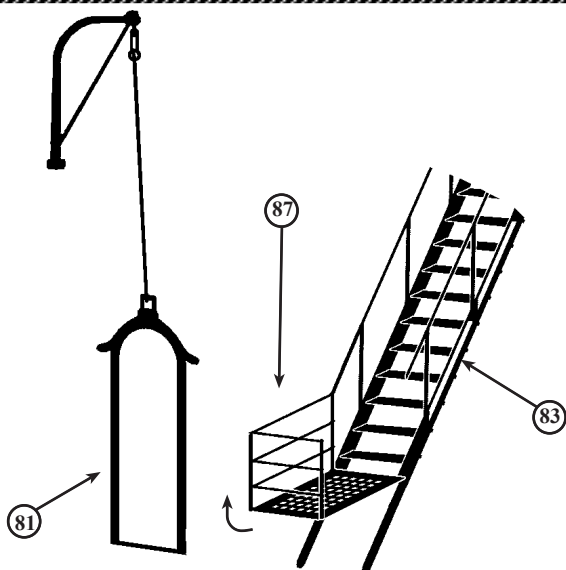

The accommodation ladders are supported over the ship's side by means of a davit & yoke system in most cases. The yoke, etched part 81, is fitted with the bottom of the legs placed each side of the outer edge of the lower landing as shown above. The davit supplied shown above is not supplied in this set but is being used to show how the ladder yoke is rigged to the ship's fittings.

OPTICAL SIGHT COVERS

Assemble the optical sight covers by folding back the side frames to form a pyramid-type structure.

Fit the covers onto the circular base plate, fitting the bottom edges to the relief-etched lines as shown right.

Fit these items around the outer edge of the platform, kit part D7, having first removed the moulded circular items from the platform. Fit four to each side.

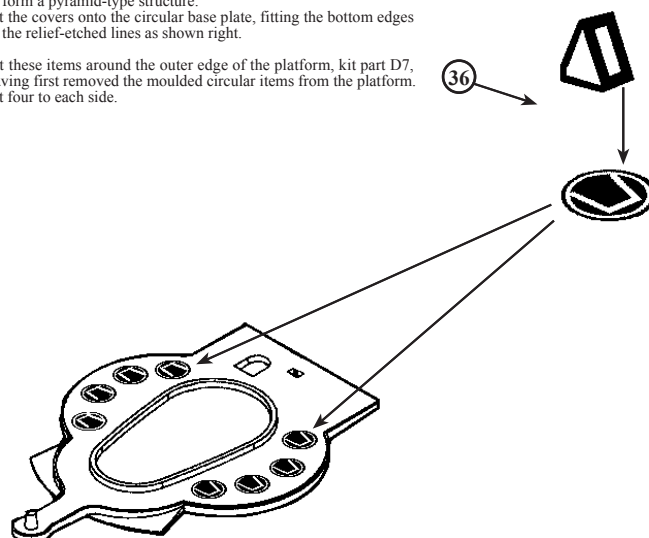

OTHER INSTRUCTIONS

1. Louvre vent grilles, etched parts 57 & 59 are designed to wrap around the boxes moulded onto the lower superstructure deck, just forward of the boat cradles. Part 57 has one section that is larger than the other three and this overlaps the superstructure side. These grilles are fitted to the box under the aft set of motor boat cradles. The moulded boxes will require being cut back to a size where the grilles will fit around them.
2. Etched parts 31 & 32 are the rigging lines for the boat crane jibs, kit parts F9. The short length is for when the jib is raised, the long lengths for stowed. One end of the rigging--the end with the attachment plates--fits onto the side of the mainmast, kit part B28, replacing the moulded brackets on the sides; the other end fits over the outer end of the crane jib. The pulley wheel at the outer end folds back on it's self to become double-thickness. The attachment plate on the inner end also folds double. A pair of crane hooks have also been supplied, etched parts 38, the pulley blocks of which also fold double-thickness.
3. Etched parts 29 are the wide ladders that allow access over the foc'sle breakwater. These fold along the centreline to form a triangle when fitted in place of the moulded plastic ladders on the breakwater, kit part B36.
4. Leadsman's platforms, etched parts 39, may be fitted if desired to the edges of the deck adjacent to 'B' Turret. Fold up the railing sections to 90° & shape to fit around the edges of the platforms.
5. Boat cradles have been supplied to replace those moulded to the deck of the kit. It is apparent that there are more boats & cradles supplied in the kit than are actually required, as *Roma's* boat fit was somewhat reduced from those her sister ships carried. Boat cradles, etched parts 41, are for the 4-metre dinghys fitted to the fore deck behind 'A' Turret, the boats being kit parts J25. Cradles, etched parts 42, are for the 10-metre motor boats stowed on top of the vent boxes on the lower superstructure. Boats made up of kit parts G2 & G6 are fitted in these--2 only. Etched parts 77 are the cradles for the large 13-metre launch that is stowed on the port side of the quarterdeck--one only. Etched parts 78 are for the 4 lifeboats made using hulls kit parts J3. These are located amidships on the main deck--4 only. Remove all the moulded cradles & replace only these. The moulded cradles on top of the aft superstructure should also be removed. Replace only the centre cradles for the two 12.5-metre motor boats, using only the inner cradles from etched parts 66.
6. Etched parts 74 & 75 are an additional pair of inclined ladders that fit to the lower superstructure sides, amidships & forward of an existing pair of ladders. The remaining inclined & vertical ladders that are to be fitted to the model are all those supplied in the kit's PE set as they are perfectly adequate.
7. The top plate for the catapult assembly, etched part 64, is included for fitting to the top surface of the catapult in place of kit part A31.
8. Anchor chain, etched parts 94, has been supplied in sufficient quantity to allow for an at-anchor diorama to be modelled, as well as the normal chain that is fitted from the capstans to the hawsepipes.
9. Etched parts 91 are the internal parts for the 3.5-metre punts that are located on the foc'sle adjacent to 'A' Turret, kit parts D31. Although these are normally stowed inverted, the parts have been supplied as an option so that these punts may be used in a diorama. The etched parts are assemble in the same way as shown for the open boats in a previous section.